



MAKE WORK
LIFE EASIER



INTELLIGENT
TORCH SOLUTIONS

ARC M SERIES



A Passion for Technology & Innovation

To produce hand tools that reach the pinnacle of performance, durability and functionality you have to be passionate about what you do.

At Arc Torchology the research and development department is the beating heart of our company.

Every single component is conceived, developed, manufactured and tested in-house.

Our development and testing activities are loaded with cutting edge technologies, many of which have been developed specifically by us to meet the very stringent demands we place on our design solutions.

These specialized, bespoke solutions allow us to develop products that surpass the prerequisite of industry standards, inventing increasingly more beneficial products that deliver maximum results for the operator.

This is not business as usual.



find out more arctorchology.com

Contents

	Arc M Range Overview and Ratings	2
Torch Range		
Industrial Air-Cooled Series	M1	8
	M18	10
	M2	12
	M22	14
Industrial Air-Cooled Series - Multijust	M2M	16
	M22M	18
High Performance Air-Cooled Series	M3 <i>New</i>	20
	M4 <i>New</i>	22
	M5 <i>New</i>	24
	M6 <i>New</i>	26
High Performance Liquid-Cooled Series	M5W	28
	M55W	30
	M65W/M65WS	32
	M65WLP	34
Wear Parts		
	Industrial Series	36
	High Performance Series	39

AIR-COOLED

Arc M Industrial Mig Series



MAKE WORK
LIFE EASIER

TECHNICAL SPECIFICATIONS

IEC/EN 60974-7

M1

Cooling Method	Air-Cooled	
Rating:	CO ₂	180A
	Mixed Gas M21	150A
Duty Cycle	60%	
Wire Size	0.6-1.0mm	

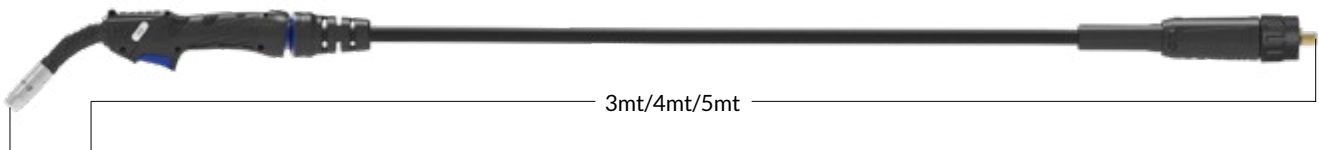

M18

Cooling Method	Air-Cooled	
Rating:	CO ₂	210A
	Mixed Gas M21	180A
Duty Cycle	60%	
Wire Size	0.6-1.0mm	

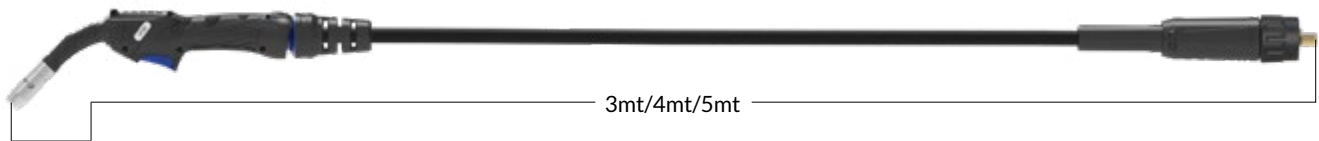

M2

Cooling Method	Air-Cooled	
Rating:	CO ₂	230A
	Mixed Gas M21	200A
	Pulse	110A
Duty Cycle	60%	
Wire Size	0.8-1.2mm	



M2 Video

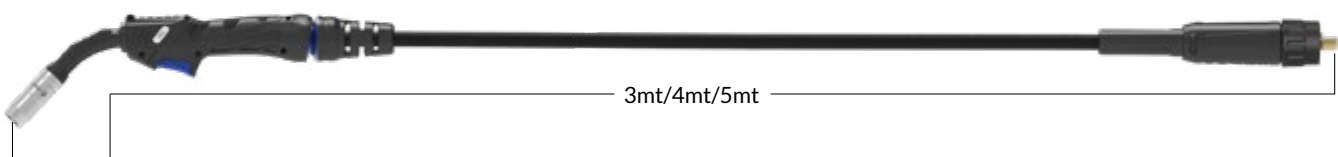

M22

Cooling Method	Air-Cooled	
Rating:	CO ₂	250A
	Mixed Gas M21	220A
	Pulse	120A
Duty Cycle	60%	
Wire Size	0.8-1.2mm	

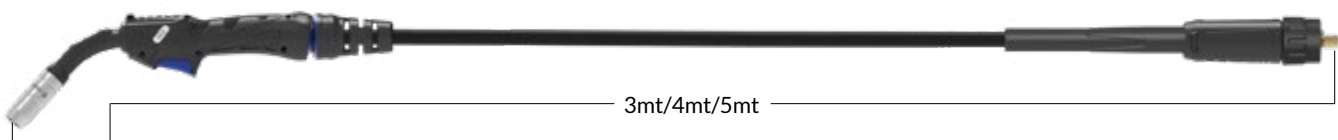

AIR-COOLED

Arc M Industrial Mig Series - Multijust



MAKE WORK
LIFE EASIER

M2M Multijust

Cooling Method	Air-Cooled	
Rating:	CO ₂	230A
	Mixed Gas M21	200A
	Pulse	110A
Duty Cycle	60%	
Wire Size	0.8-1.2mm	

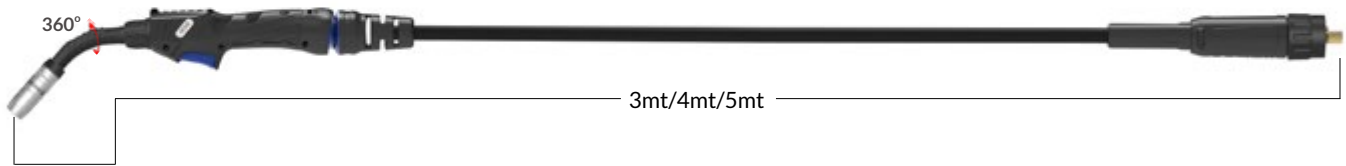

M22M Multijust

Cooling Method	Air-Cooled	
Rating:	CO ₂	250A
	Mixed Gas M21	220A
	Pulse	120A
Duty Cycle	60%	
Wire Size	0.8-1.2mm	

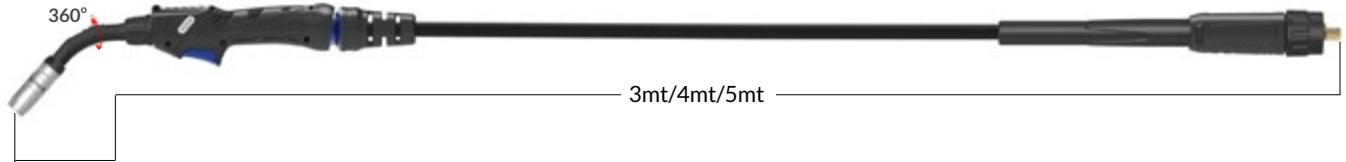

AIR-COOLED

Arc M High Performance Mig Series



MAKE WORK
LIFE EASIER

New
M3

Cooling Method	Air-Cooled	Max. Load
	CO ₂	300A 10.5KW
Rating: Mixed Gas M21	270A	8.9KW
Duty Cycle	60%	
Wire Size	0.9-1.2mm	

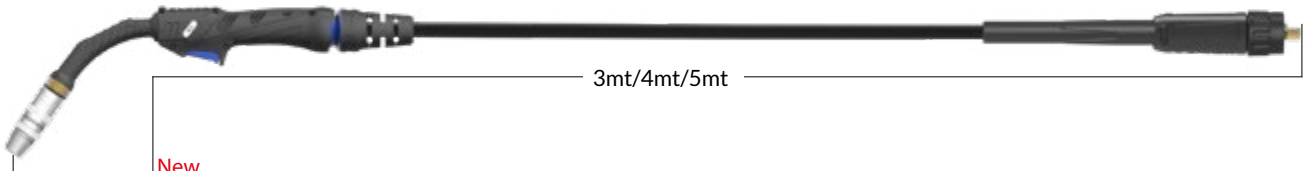

New
M4

Cooling Method	Air-Cooled	Max. Load
	CO ₂	350A 14.1KW
Rating: Mixed Gas M21	320A	11.4KW
Duty Cycle	60%	
Wire Size	0.9-1.2mm	

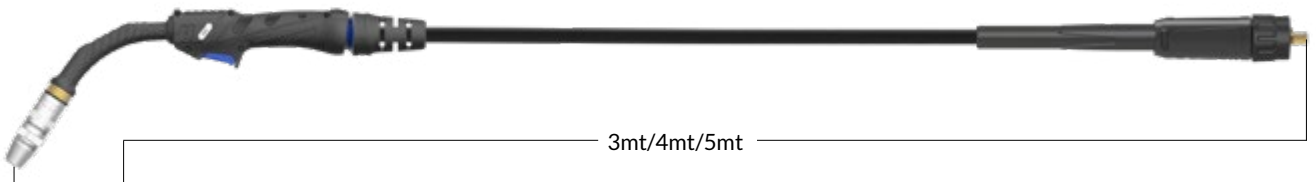

New
M5

Cooling Method	Air-Cooled	Max. Load
	CO ₂	390A 14.6KW
Rating: Mixed Gas M21	360A	12.2KW
Duty Cycle	60%	
Wire Size	0.9-1.6mm	



M5 Video

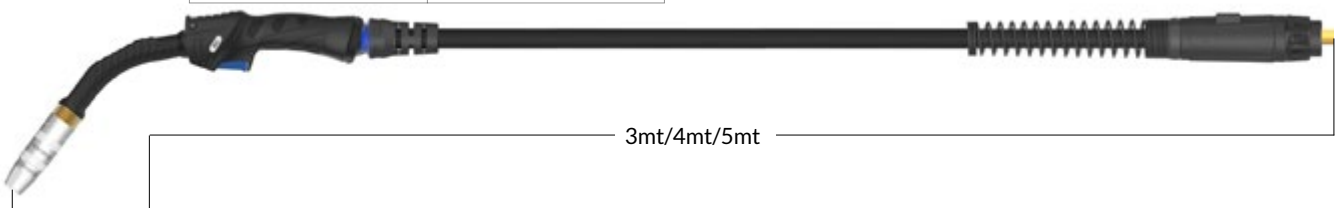

New
M6

Cooling Method	Air-Cooled	Max. Load
	CO ₂	430A 17.6KW
Rating: Mixed Gas M21	400A	14.8KW
Duty Cycle	60%	
Wire Size	0.9-2.0mm	

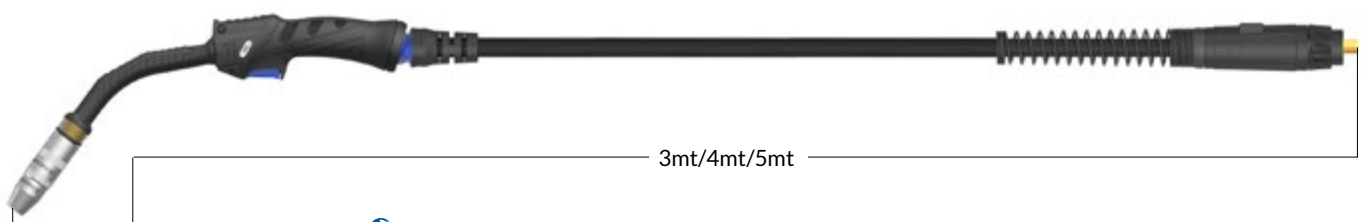

LIQUID-COOLED

Arc M High Performance Mig Series



MAKE WORK
LIFE EASIER

M5W

Cooling Method	Liquid-Cooled			
	Cooler Rating	Max. A	Pulse	Max. Load
Rating: CO ₂	1600W	560A	-	24KW
	1200W	540A	-	22KW
	1000W	510A	-	20KW
Rating: Mixed Gas M21	1600W	540A	380A	22KW
	1200W	520A	350A	21KW
	1000W	500A	340A	19.5KW
Duty Cycle		100%	100%	
Wire Size	Filler Wires	Fe, Fe-MC / FC		0.9-1.6mm
	Filler Wires	Ss, Ss-MC / FC		0.9-1.6mm
	Filler Wires	Al		1.0-1.6mm
Minimum Liquid Flow Rate	1.5 l/min		Important: Please note minimum inlet pressure and flow rate. Low pressure will affect torch performance	
Minimum Liquid Inlet Pressure	2.5 Bar			
Maximum Liquid Inlet Pressure	5.0 Bar			
Maximum Liquid Inlet Temperature	50°C			
Operating Temperature Range	-10...+40°C			



M5W Video

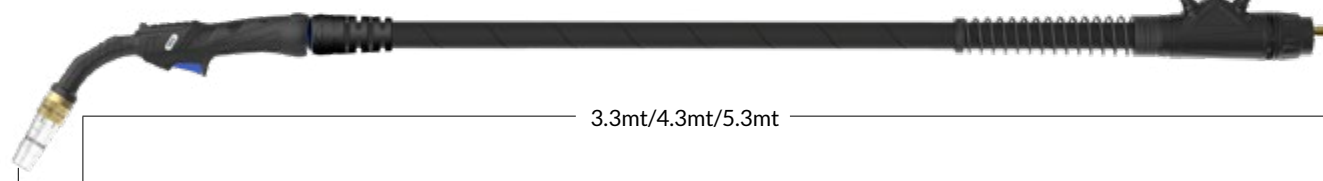

M55W

Cooling Method	Liquid-Cooled			
	Cooler Rating	Max. A	Pulse	Max. Load
Rating: CO ₂	1600W	580A	-	25KW
	1200W	550A	-	23KW
	1000W	520A	-	21KW
Rating: Mixed Gas M21	1600W	560A	400A	23KW
	1200W	530A	360A	21.5KW
	1000W	510A	350A	20KW
Duty Cycle		100%	100%	
Wire Size	Filler Wires	Fe, Fe-MC / FC		0.9-2.0mm
	Filler Wires	Ss, Ss-MC / FC		0.9-1.6mm
	Filler Wires	Al		1.0-2.0mm
Minimum Liquid Flow Rate	1.5 l/min		Important: Please note minimum inlet pressure and flow rate. Low pressure will affect torch performance	
Minimum Liquid Inlet Pressure	2.5 Bar			
Maximum Liquid Inlet Pressure	5.0 Bar			
Maximum Liquid Inlet Temperature	50°C			
Operating Temperature Range	-10...+40°C			

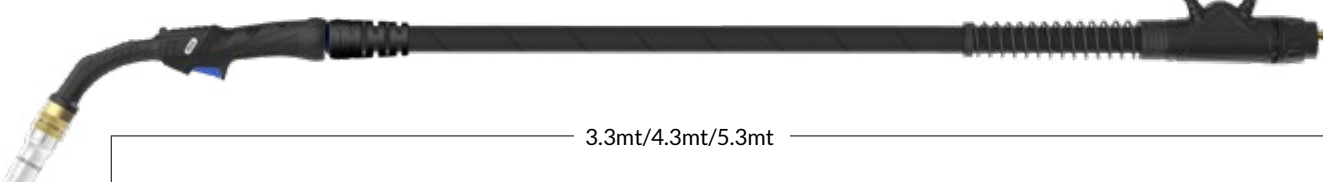

The design, manufacturing and quality systems of Arc Torchology are certified by **BVQI** in accordance with EN/ISO 9001:2015

LIQUID-COOLED

Arc M High Performance Mig Series



MAKE WORK
LIFE EASIER

M65W/M65WS

Cooling Method	Liquid-Cooled			
	Cooler Rating	Max. A	Pulse	Max. Load
Rating: CO ₂	1600W	580A	-	25KW
	1200W	550A	-	23KW
	1000W	520A	-	21KW
Rating: Mixed Gas M21	1600W	560A	400A	23KW
	1200W	530A	360A	21.5KW
	1000W	510A	350A	20KW
Duty Cycle		100%	100%	
Wire Size	Filler Wires	Fe, Fe-MC / FC		0.9-2.0mm
	Filler Wires	Ss, Ss-MC / FC		0.9-1.6mm
	Filler Wires	Al		1.0-2.0mm
Minimum Liquid Flow Rate	1.5 l/min		Important: Please note minimum inlet pressure and flow rate. Low pressure will affect torch performance	
Minimum Liquid Inlet Pressure	2.5 Bar			
Maximum Liquid Inlet Pressure	5.0 Bar			
Maximum Liquid Inlet Temperature	50°C			
Operating Temperature Range	-10...+40°C			

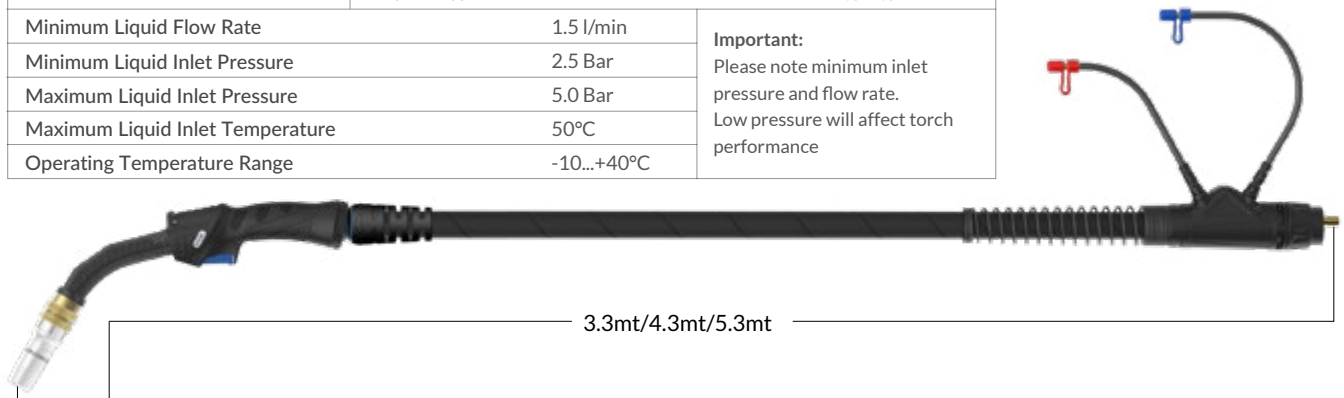

LIQUID-COOLED

Arc M High Performance Mig Series



MAKE WORK
LIFE EASIER

M65WLP

Cooling Method	Liquid-Cooled			
	Cooler Rating	Max. A	Pulse	Max. Load
Rating: CO ₂	1600W	590A	-	26KW
	1200W	560A	-	24KW
	1000W	530A	-	22KW
Rating: Mixed Gas M21	1600W	570A	420A	24KW
	1200W	530A	380A	22KW
	1000W	500A	360A	19.5KW
Duty Cycle		100%	100%	
Wire Size	Filler Wires	Fe, Fe-MC / FC		0.9-2.0mm
	Filler Wires	Ss, Ss-MC / FC		0.9-1.6mm
	Filler Wires	Al		1.0-2.0mm
Minimum Liquid Flow Rate	1.5 l/min		Important: Please note minimum inlet pressure and flow rate. Low pressure will affect torch performance	
Minimum Liquid Inlet Pressure	2.5 Bar			
Maximum Liquid Inlet Pressure	5.0 Bar			
Maximum Liquid Inlet Temperature	50°C			
Operating Temperature Range	-10...+40°C			



M1 Air-Cooled Mig Welding Torch

Ratings:	180A CO ₂ , 150A mixed gas M21, EN60974-7 @ 60% duty cycle. 0.6mm-1.0mm wires
----------	---

The Arc M1 is the same size as an MB15 yet 20% lighter

ARC M INDUSTRIAL MIG TORCH PACKAGES

M1 Torches are supplied with a Euro termination as standard and are supplied 'ready to weld' with all wear parts fitted.

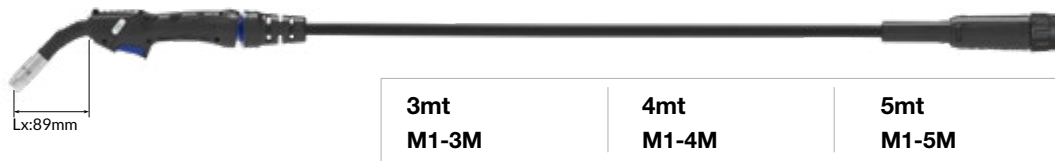

Wear Parts

A Nozzles

Part Number	Description	Bore	Wall	Material
•AM1CN	Conical Nozzle Assembly	12mm	1.0mm	Copper
AM1TN	Tapered Nozzle Assembly	10.6mm	1.0mm	Copper

B Contact Tips

Part Number	Description	Size (mm)	Wire Size (mm-inch)	Material
AM1CT06	Contact Tip	M6*25.0	0.6 - 0.023	Copper
•AM1CT08	Contact Tip	M6*25.0	0.8 - 0.030	Copper
AM1CT09	Contact Tip	M6*25.0	0.9 - 0.035	Copper
AM1CT10	Contact Tip	M6*25.0	1.0 - 0.040	Copper
AM1CT12	Contact Tip	M6*25.0	1.2 - 0.045	Copper
AM1CT08A	Contact Tip	M6*25.0	0.8 - 0.030	Copper
AM1CT10A	Contact Tip	M6*25.0	1.0 - 0.040	Copper
AM1CT12A	Contact Tip	M6*25.0	1.2 - 0.045	Copper

C Tip Adaptors

Part Number	Description	Material
•AM1TA	Tip Adaptor	Brass

•Denotes torch package standard wear part set-up

D Liners

Part Number	Description	Wire Size
•AM1535-30	Steel Liner x 3mt	0.6-0.9mm
•AM1535-40	Steel Liner x 4mt	0.6-0.9mm
•AM1535-50	Steel Liner x 5mt	0.6-0.9mm

For alternate liner options please refer to page 38

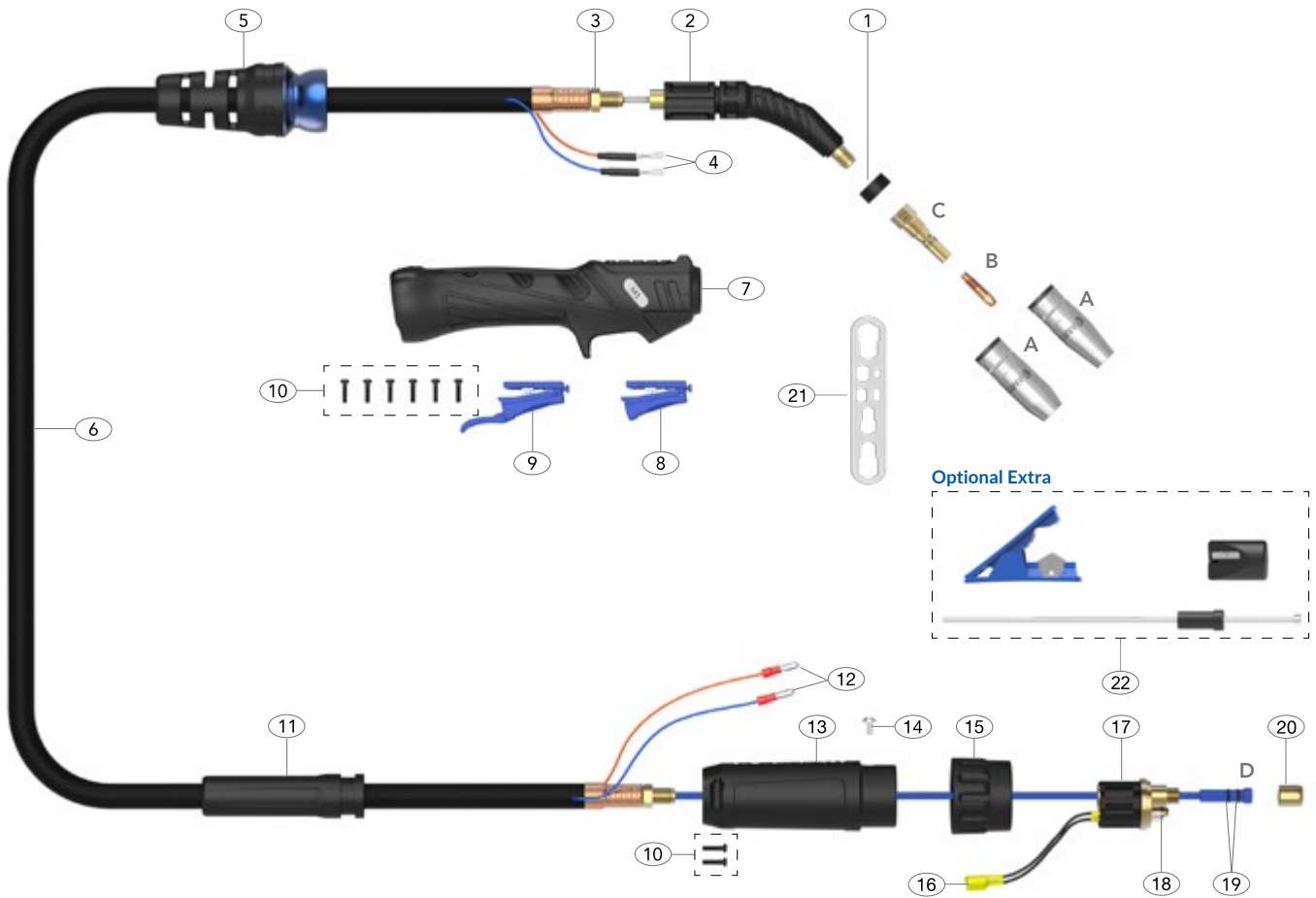

Spare Parts

Part Number	Description
1	AM1AP Neck Insulator
2	AM1001 Swan Neck Assembly
3	AM1505 Lock Nut
4	AM1521 Cable Terminal
5	AM1514 Handle Cable Support c/w Ball Joint
6	AM1517-30 Ultraflex Cable Assembly x 3mt AM1517-40 Ultraflex Cable Assembly x 4mt AM1517-50 Ultraflex Cable Assembly x 5mt
7	AM2514 Handle Kit
8	AM2516 Microswitch Standard Trigger
9	AM2516L Microswitch Extended Trigger
10	AMSP1-1 Screw Pack
11	AM2841 Cable Support
12	AM1522 Cable Terminal Male
13	AM2578/S Gun Plug Housing
14	AML1541 Gun Plug Screw
15	AMC1519/S Gun Plug Nut
16	AM1523 Gun Plug Terminal Female

Part Number	Description
17	AM1528 Hybrid Gun Plug Body c/w Spring Pins
18	AM1524 Gun Plug 'O' Ring
19	AMLOR Liner 'O' Ring
20	AM1826 Liner Retaining Nut
21	AMWS Wear Parts Spanner
Optional Extra	
22	AMCLST-KITS Combi-Liner Set-up kit

Welding with Soft Wires

For welding with Aluminum wires use a Combi-liner (page 38). Optimum installation is achieved when using the Combi-liner set-up kit.



Liner Set-up Guide

Always follow the correct liner installation procedure

M18 Air-Cooled Mig Welding Torch

Ratings:	210A CO ₂ , 180A mixed gas M21, EN60974-7 @ 60% duty cycle. 0.6mm-1.0mm wires
----------	---

The same footprint as an M1 with improved power rating.
Ideal for 0.8mm hard wires and semi-industrial environments.

ARC M INDUSTRIAL MIG TORCH PACKAGES

M18 Torches are supplied with a Euro termination as standard and are supplied 'ready to weld' with all wear parts fitted.

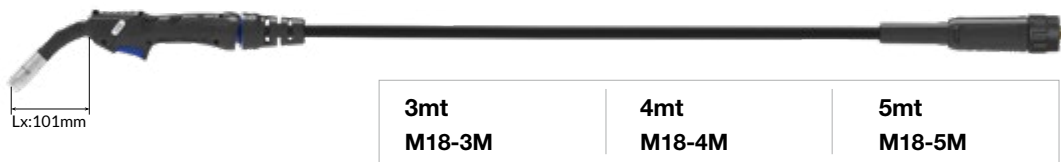

Wear Parts

A Nozzles

Part Number	Description	Bore	Wall	Material
•AM18CN	Conical Nozzle Assembly	14mm	1.5mm	Copper
AM18TN	Tapered Nozzle Assembly	12mm	1.5mm	Copper

B Contact Tips

Part Number	Description	Size (mm)	Wire Size (mm-inch)	Material
AM1CT06	Contact Tip	M6*25.0	0.6 - 0.023	Copper
•AM1CT08	Contact Tip	M6*25.0	0.8 - 0.030	Copper
AM1CT09	Contact Tip	M6*25.0	0.9 - 0.035	Copper
AM1CT10	Contact Tip	M6*25.0	1.0 - 0.040	Copper
AM1CT12	Contact Tip	M6*25.0	1.2 - 0.045	Copper
AM1CT08A	Contact Tip	M6*25.0	0.8 - 0.030	Copper
AM1CT10A	Contact Tip	M6*25.0	1.0 - 0.040	Copper
AM1CT12A	Contact Tip	M6*25.0	1.2 - 0.045	Copper

C Tip Adaptors

Part Number	Description	Material
•AM18TA	Tip Adaptor	Brass

• Denotes torch package standard wear part set-up

D Liners

Part Number	Description	Wire Size
•AM1535-30	Steel Liner x 3mt	0.6-0.9mm
•AM1535-40	Steel Liner x 4mt	0.6-0.9mm
•AM1535-50	Steel Liner x 5mt	0.6-0.9mm

For alternate liner options please refer to page 38

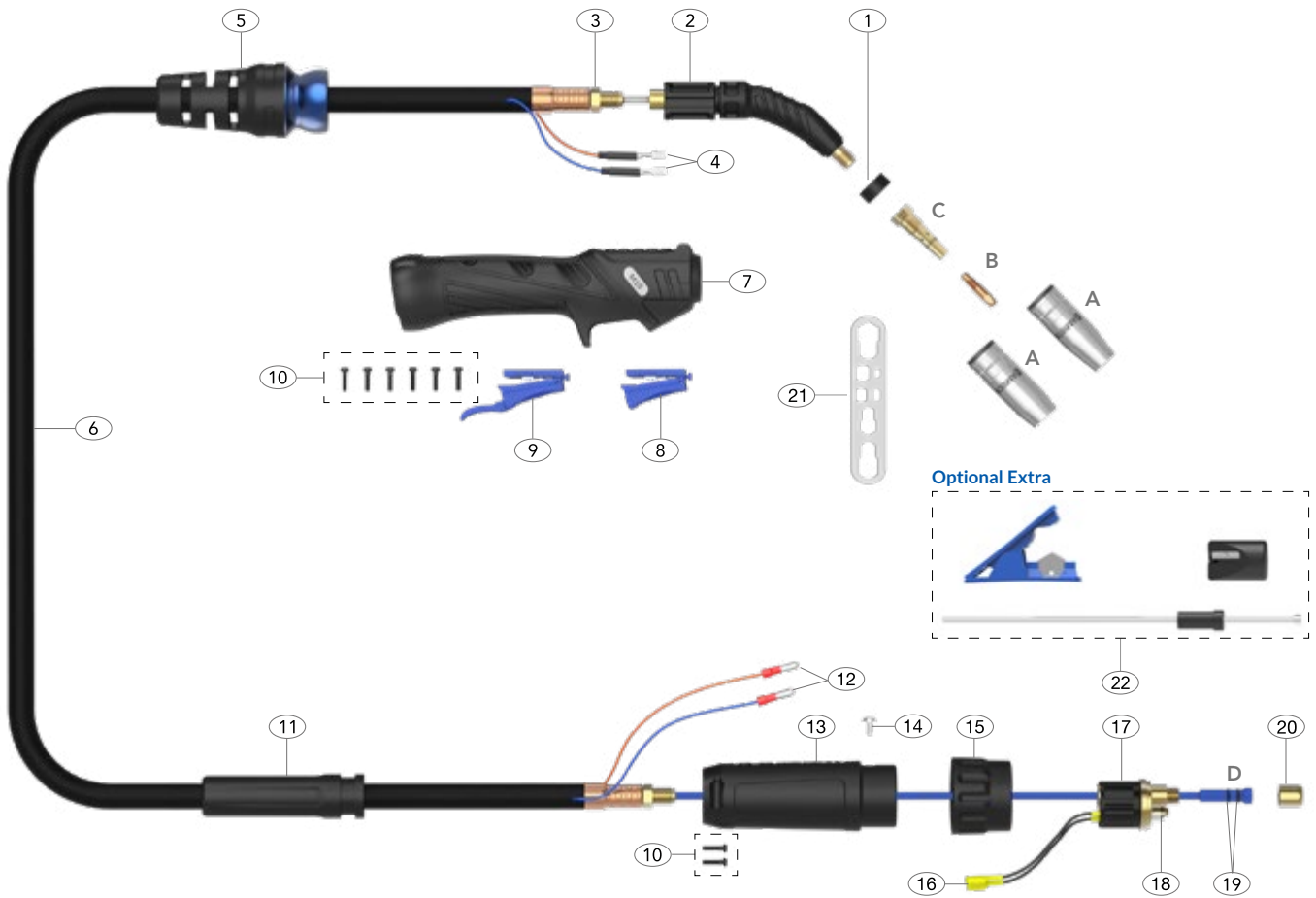

Spare Parts

Part Number	Description
1 AM18AP	Neck Insulator
2 AM18001	Swan Neck Assembly
3 AM1505	Lock Nut
4 AM1521	Cable Terminal
5 AM1514	Handle Cable Support c/w Ball Joint
6 AM1817-30	Ultraflex Cable Assembly x 3mt
AM1817-40	Ultraflex Cable Assembly x 4mt
AM1817-50	Ultraflex Cable Assembly x 5mt
7 AM2514	Handle Kit
8 AM2516	Microswitch Standard Trigger
9 AM2516L	Microswitch Extended Trigger
10 AMSP1-1	Screw Pack
11 AM2841	Cable Support
12 AM1522	Cable Terminal Male
13 AM2578/S	Gun Plug Housing
14 AML1541	Gun Plug Screw
15 AMC1519/S	Gun Plug Nut
16 AM1523	Gun Plug Terminal Female

Part Number	Description
17 AM1528	Hybrid Gun Plug Body c/w Spring Pins
18 AM1524	Gun Plug 'O' Ring
19 AMLOR	Liner 'O' Ring
20 AM1826	Liner Retaining Nut
21 AMWS	Wear Parts Spanner
Optional Extra	
22 AMCLST-KITS	Combi-Liner Set-up kit

Welding with Soft Wires

For welding with Aluminum wires use a Combi-liner (page 38). Optimum installation is achieved when using the Combi-liner set-up kit.



Liner Set-up Guide

Always follow the correct liner installation procedure

M2 Air-Cooled Mig Welding Torch

Ratings:	230A CO ₂ , 200A mixed gas M21, 110A pulse. EN60974-7 @ 60% duty cycle. 0.8mm-1.2mm wires
----------	---

The Arc M2 is the same size as an MB25 yet 20% lighter.
Ideal for 0.8-1.0mm hard wires and industrial environments.



M2 Video

ARC M INDUSTRIAL MIG TORCH PACKAGES

M2 Torches are supplied with a Euro termination as standard and are supplied 'ready to weld' with all wear parts fitted.



Wear Parts

A Nozzles

Part Number	Description	Bore	Wall	Material
•AM2CN	Conical Nozzle Assembly	15mm	1.9mm	Copper
AM2TN	Tapered Nozzle Assembly	12mm	1.9mm	Copper

B Contact Tips

Part Number	Description	Size (mm)	Wire Size (mm-inch)	Material
AM2CT08	Contact Tip	M8*29.5	0.8 - 0.030	Copper
AM2CT09	Contact Tip	M8*29.5	0.9 - 0.035	Copper
•AM2CT10	Contact Tip	M8*29.5	1.0 - 0.040	Copper
AM2CT12	Contact Tip	M8*29.5	1.2 - 0.045	Copper
AM2CT08A	Contact Tip	M8*29.5	0.8 - 0.030	Copper
AM2CT10A	Contact Tip	M8*29.5	1.0 - 0.040	Copper
AM2CT12A	Contact Tip	M8*29.5	1.2 - 0.045	Copper

C Tip Adaptors

Part Number	Description	Material
•AM2TA	Tip Adaptor	Brass

•Denotes torch package standard wear part set-up

D Liners

Part Number	Description	Wire Size
•AM2524-30	Steel Liner x 3mt	1.0-1.2mm
•AM2524-40	Steel Liner x 4mt	1.0-1.2mm
•AM2524-50	Steel Liner x 5mt	1.0-1.2mm

For alternate liner options please refer to page 38

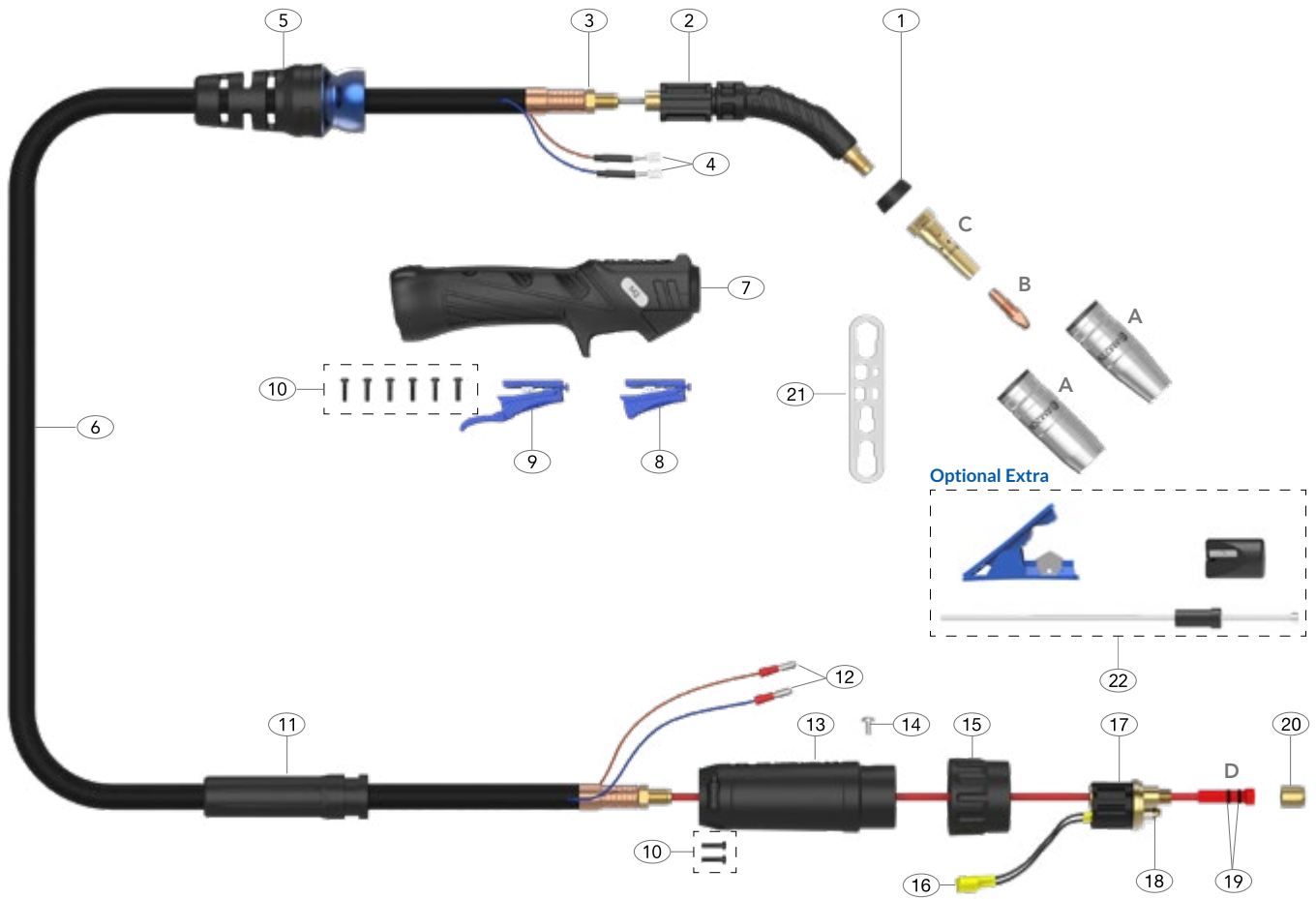

Spare Parts

Part Number	Description
1 AM2AP	Neck Insulator
2 AM2001	Swan Neck Assembly
3 AM1505	Lock Nut
4 AM1521	Cable Terminal
5 AM1514	Handle Cable Support c/w Ball Joint
6 AM2503-30	Ultraflex Cable Assembly x 3mt
AM2503-40	Ultraflex Cable Assembly x 4mt
AM2503-50	Ultraflex Cable Assembly x 5mt
7 AM2514	Handle Kit
8 AM2516	Microswitch Standard Trigger
9 AM2516L	Microswitch Extended Trigger
10 AMSP1-1	Screw Pack
11 AM2841	Cable Support
12 AM1522	Cable Terminal Male
13 AM2578/S	Gun Plug Housing
14 AML1541	Gun Plug Screw
15 AMC1519/S	Gun Plug Nut
16 AM1523	Gun Plug Terminal Female

Part Number	Description
17 AM1528	Hybrid Gun Plug Body c/w Spring Pins
18 AM1524	Gun Plug 'O' Ring
19 AMLOR	Liner 'O' Ring
20 AM1826	Liner Retaining Nut
21 AMWS	Wear Parts Spanner
Optional Extra	
22 AMCLST-KITS	Combi-Liner Set-up kit

Welding with Soft Wires

For welding with Aluminum wires use a Combi-liner (page 38). Optimum installation is achieved when using the Combi-liner set-up kit.



Liner Set-up Guide

Always follow the correct liner installation procedure

M22 Air-Cooled Mig Welding Torch

Ratings:	250A CO ₂ , 220A mixed gas M21, 120A pulse. EN60974-7 @ 60% duty cycle. 0.8mm-1.2mm wires
----------	---

The Arc M22 is the same size as an MB24 yet 20% lighter.
A great all-round Industrial torch for high duty 200 Amp solid wires and low duty Pulse Mig Aluminium applications.

ARC M INDUSTRIAL MIG TORCH PACKAGES

M22 Torches are supplied with a Euro termination as standard and are supplied 'ready to weld' with all wear parts fitted.

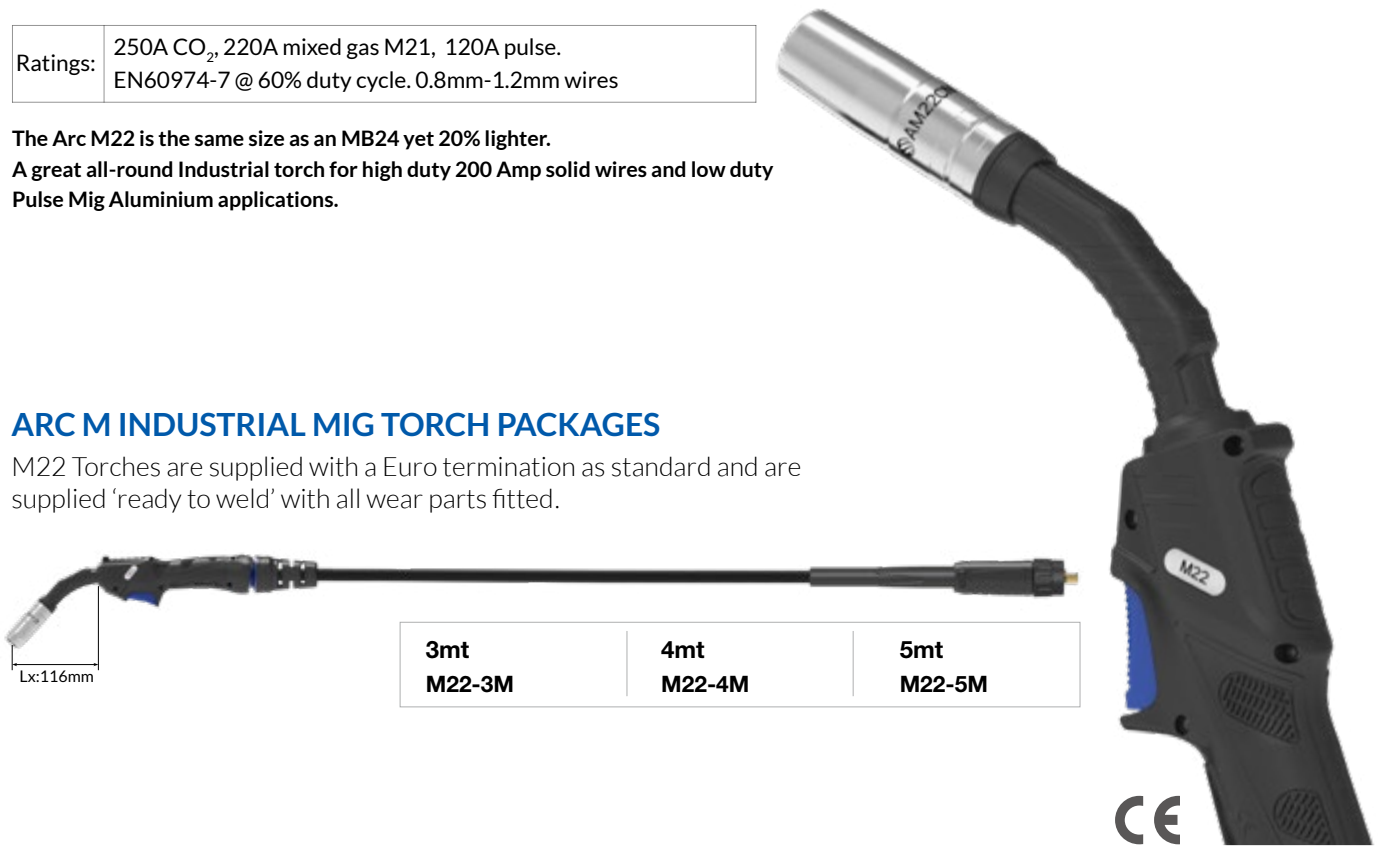

3mt M22-3M	4mt M22-4M	5mt M22-5M
-----------------------------	-----------------------------	-----------------------------

Wear Parts

A Nozzles

Part Number	Description	Bore	Wall	Material
•AM22CN	Conical Nozzle Assembly	16mm	1.75mm	Copper
AM22CNHD	Conical Nozzle HD Assembly	16mm	2.00mm	Copper
AM22TN	Tapered Nozzle Assembly	14mm	1.75mm	Copper

D Liners

Part Number	Description	Wire Size
•AM2524-30	Steel Liner x 3mt	1.0-1.2mm
•AM2524-40	Steel Liner x 4mt	1.0-1.2mm
•AM2524-50	Steel Liner x 5mt	1.0-1.2mm

For alternate liner options please refer to page 38

B Contact Tips

Part Number	Description	Size (mm)	Wire Size (mm-inch)	Material
AM2CT08	Contact Tip	M8*29.5	0.8 - 0.030	Copper
AM2CT09	Contact Tip	M8*29.5	0.9 - 0.035	Copper
•AM2CT10	Contact Tip	M8*29.5	1.0 - 0.040	Copper
AM2CT12	Contact Tip	M8*29.5	1.2 - 0.045	Copper
AM2CT08A	Contact Tip	M8*29.5	0.8 - 0.030	Copper
AM2CT10A	Contact Tip	M8*29.5	1.0 - 0.040	Copper
AM2CT12A	Contact Tip	M8*29.5	1.2 - 0.045	Copper

Arc Conical HD Nozzle
Ideal for High Amperage and Pulse Welding

C Tip Adaptors

Part Number	Description	Material
•AM22TA	Tip Adaptor	Brass

•Denotes torch package standard wear part set-up

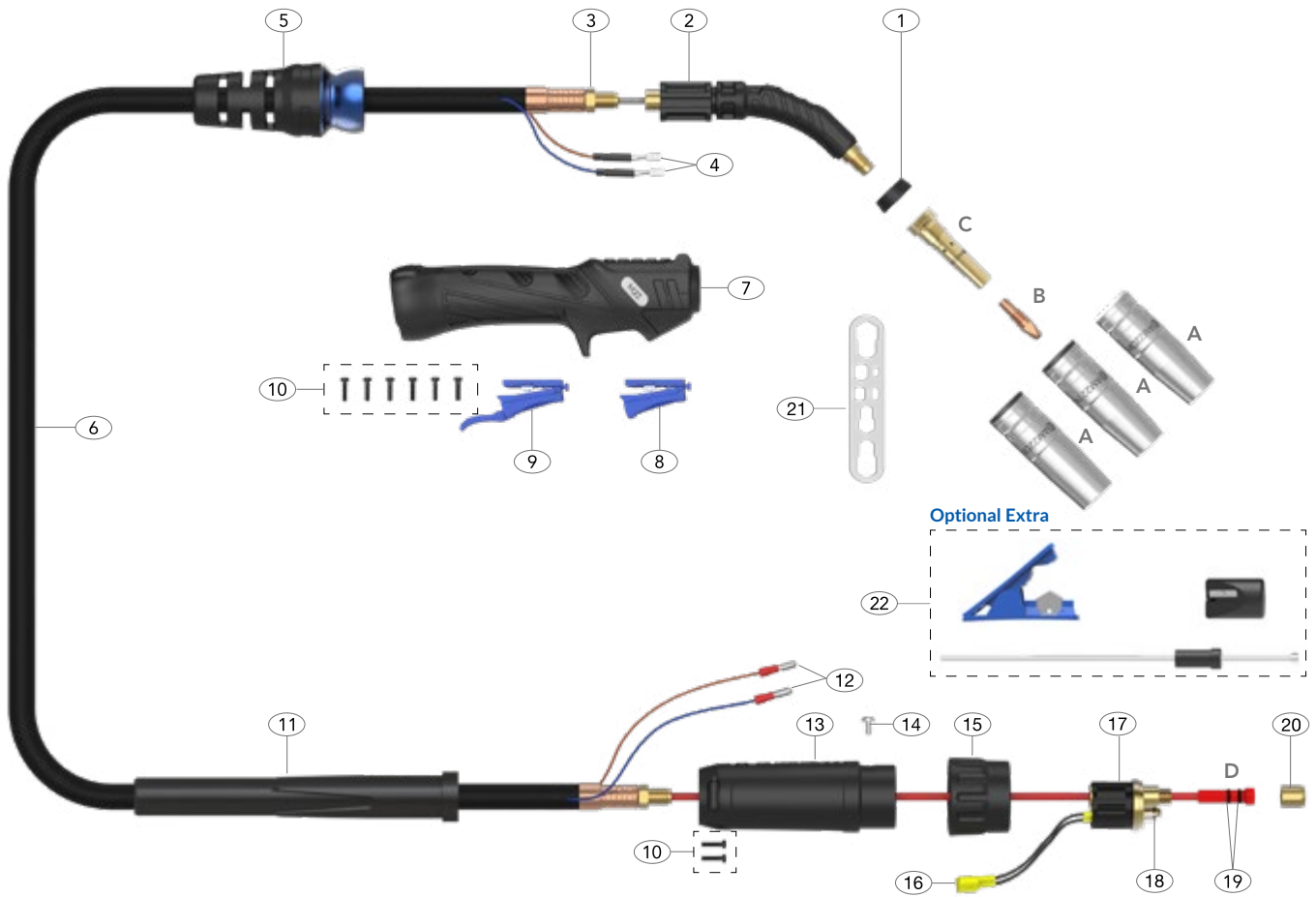

Spare Parts

Part Number	Description
1 AM2AP	Neck Insulator
2 AM22001	Swan Neck Assembly
3 AM1505	Lock Nut
4 AM1521	Cable Terminal
5 AM1514	Handle Cable Support c/w Ball Joint
6 AM2603-30	Ultraflex Cable Assembly x 3mt
AM2603-40	Ultraflex Cable Assembly x 4mt
AM2603-50	Ultraflex Cable Assembly x 5mt
7 AM2514	Handle Kit
8 AM2516	Microswitch Standard Trigger
9 AM2516L	Microswitch Extended Trigger
10 AMSP1-1	Screw Pack
11 AMPA3541	Cable Support
12 AM1522	Cable Terminal Male
13 AM2578/L	Gun Plug Housing
14 AML1541	Gun Plug Screw
15 AMC1519/S	Gun Plug Nut
16 AM1523	Gun Plug Terminal Female

Part Number	Description
17 AM1528	Hybrid Gun Plug Body c/w Spring Pins
18 AM1524	Gun Plug 'O' Ring
19 AMLOR	Liner 'O' Ring
20 AM1826	Liner Retaining Nut
21 AMWS	Wear Parts Spanner
Optional Extra	
22 AMCLST-KITS	Combi-Liner Set-up kit

Welding with Soft Wires

For welding with Aluminum wires use a Combi-liner (page 38). Optimum installation is achieved when using the Combi-liner set-up kit.



Liner Set-up Guide

Always follow the correct liner installation procedure

M2M Air-Cooled Mig Welding Torch - Multijust

Ratings:	230A CO ₂ , 200A mixed gas M21, 110A pulse. EN60974-7 @ 60% duty cycle. 0.8mm-1.2mm wires
----------	---

The Arc M2M is ideal for 0.8-1.0mm hard wires and industrial environments. Fitted with a longer neck with 360° rotation, perfect for multiple positions in difficult to reach areas.



ARC M INDUSTRIAL MIG TORCH PACKAGES - MULTIJUST

M2M Multijust Torches are supplied with a Euro termination as standard and are supplied 'ready to weld' with all wear parts fitted.



Wear Parts

A Nozzles

Part Number	Description	Bore	Wall	Material
•AM2CN	Conical Nozzle Assembly	15mm	1.9mm	Copper
AM2TN	Tapered Nozzle Assembly	12mm	1.9mm	Copper

B Contact Tips

Part Number	Description	Size (mm)	Wire Size (mm-inch)	Material
AM2CT08	Contact Tip	M8*29.5	0.8 - 0.030	Copper
AM2CT09	Contact Tip	M8*29.5	0.9 - 0.035	Copper
•AM2CT10	Contact Tip	M8*29.5	1.0 - 0.040	Copper
AM2CT12	Contact Tip	M8*29.5	1.2 - 0.045	Copper
AM2CT08A	Contact Tip	M8*29.5	0.8 - 0.030	Copper
AM2CT10A	Contact Tip	M8*29.5	1.0 - 0.040	Copper
AM2CT12A	Contact Tip	M8*29.5	1.2 - 0.045	Copper

C Tip Adaptors

Part Number	Description	Material
•AM2TA	Tip Adaptor	Brass

•Denotes torch package standard wear part set-up

D Liners

Part Number	Description	Wire Size
•AM2524-30	Steel Liner x 3mt	1.0-1.2mm
•AM2524-40	Steel Liner x 4mt	1.0-1.2mm
•AM2524-50	Steel Liner x 5mt	1.0-1.2mm

For alternate liner options please refer to page 38

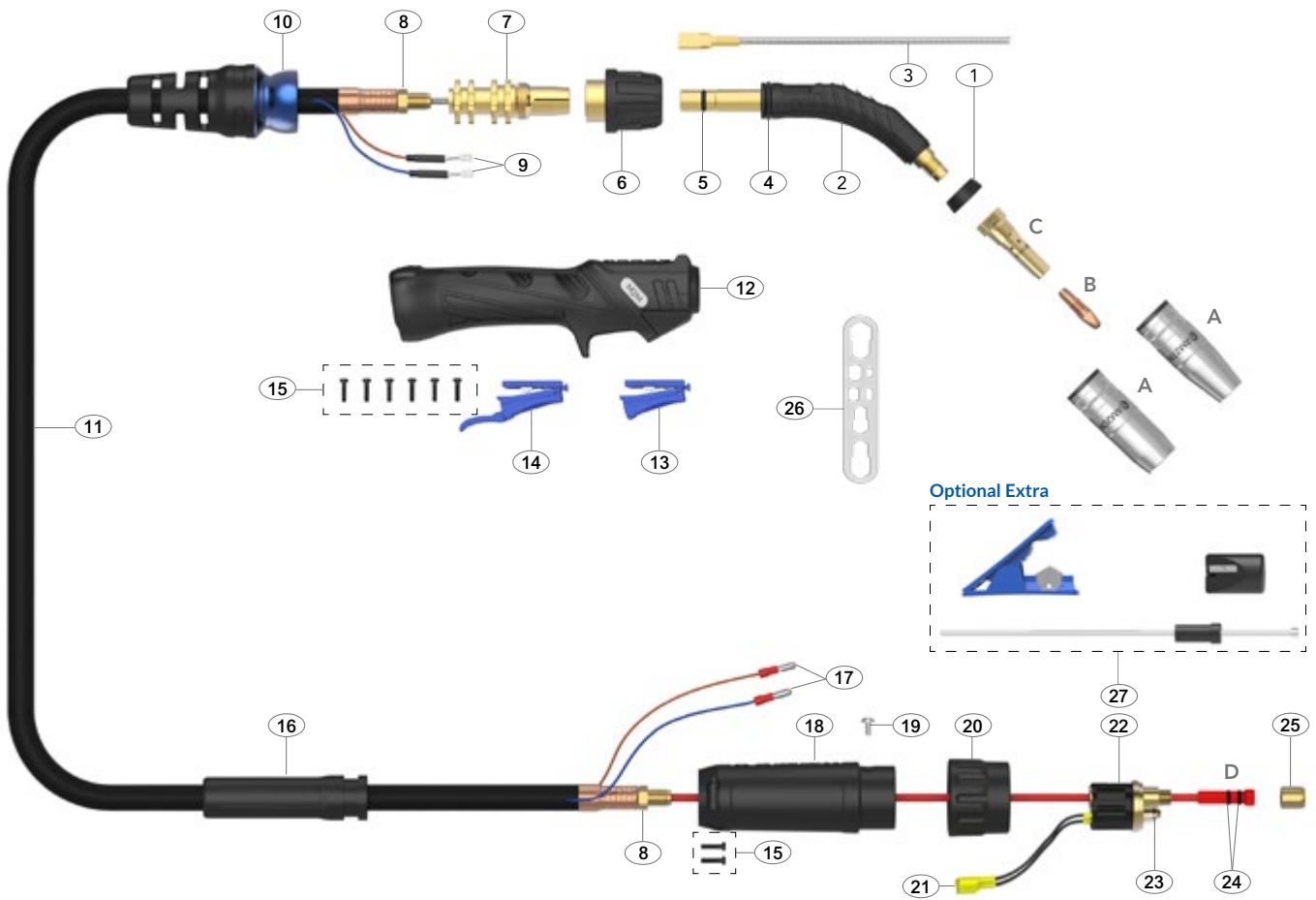

Spare Parts

Part Number	Description
1	AM2AP Neck Insulator
2	AM2001M Swan Neck Assembly - Multijust
3	AM2MJL Neck Jump Liner 0.8-1.2mm - Hard Wire
4	AM-MJ1509 Neck 'O' Ring(Ø14xØ2.5)
5	AM-MJ1508 Neck 'O' Ring(Ø8.5xØ1.5)
6	AM1516M Neck Nut - Multijust
7	AM1515M Socket Connection
8	AM1505 Lock Nut
9	AM1521 Cable Terminal
10	AM1514 Handle Cable Support c/w Ball Joint
11	AM2503-30 Ultraflex Cable Assembly x 3mt AM2503-40 Ultraflex Cable Assembly x 4mt AM2503-50 Ultraflex Cable Assembly x 5mt
12	AM2514 Handle Kit
13	AM2516 Microswitch Standard Trigger
14	AM2516L Microswitch Extended Trigger
15	AMSP1-1 Screw Pack
16	AM2841 Cable Support
17	AM1522 Cable Terminal Male
18	AM2578/S Gun Plug Housing
19	AML1541 Gun Plug Screw
20	AMC1519/S Gun Plug Nut
21	AM1523 Gun Plug Terminal Female

Part Number	Description
22	AM1528 Hybrid Gun Plug Body c/w Spring Pins
23	AM1524 Gun Plug 'O' Ring
24	AMLOR Liner 'O' Ring
25	AM1826 Liner Retaining Nut
26	AMWS Wear Parts Spanner
Optional Extra	
27	AMCLST-KITS Combi-Liner Set-up kit

Welding with Soft Wires

For welding with Aluminum wires use a Combi-liner (page 38). Optimum installation is achieved when using the Combi-liner set-up kit.

M22M Air-Cooled Mig Welding Torch - Multijust

Ratings:	250A CO ₂ , 220A mixed gas M21, 120A pulse. EN60974-7 @ 60% duty cycle. 0.8mm-1.2mm wires
----------	---

A great all-round Industrial torch for high duty 200 Amp solid wires and low duty Pulse Mig Aluminium applications.
Fitted with a longer neck with 360° rotation, perfect for multiple positions in difficult to reach areas.



ARC M INDUSTRIAL MIG TORCH PACKAGES - MULTIJUST

M22M Multijust Torches are supplied with a Euro termination as standard and are supplied 'ready to weld' with all wear parts fitted.



Wear Parts

A Nozzles

Part Number	Description	Bore	Wall	Material
•AM22CN	Conical Nozzle Assembly	16mm	1.75mm	Copper
AM22CNHD	Conical Nozzle HD Assembly	16mm	2.00mm	Copper
AM22TN	Tapered Nozzle Assembly	14mm	1.75mm	Copper

D Liners

Part Number	Description	Wire Size
•AM2524-30	Steel Liner x 3mt	1.0-1.2mm
•AM2524-40	Steel Liner x 4mt	1.0-1.2mm
•AM2524-50	Steel Liner x 5mt	1.0-1.2mm

For alternate liner options please refer to page 38

B Contact Tips

Part Number	Description	Size (mm)	Wire Size (mm-inch)	Material
AM2CT08	Contact Tip	M8*29.5	0.8 - 0.030	Copper
AM2CT09	Contact Tip	M8*29.5	0.9 - 0.035	Copper
•AM2CT10	Contact Tip	M8*29.5	1.0 - 0.040	Copper
AM2CT12	Contact Tip	M8*29.5	1.2 - 0.045	Copper
AM2CT08A	Contact Tip	M8*29.5	0.8 - 0.030	Copper
AM2CT10A	Contact Tip	M8*29.5	1.0 - 0.040	Copper
AM2CT12A	Contact Tip	M8*29.5	1.2 - 0.045	Copper

Arc Conical HD Nozzle

Recommended for High Amperage and Pulse Welding

C Tip Adaptors

Part Number	Description	Material
•AM22TA	Tip Adaptor	Brass

•Denotes torch package standard wear part set-up

INDUSTRIAL SERIES - MULTIJUST



MAKE WORK
LIFE EASIER

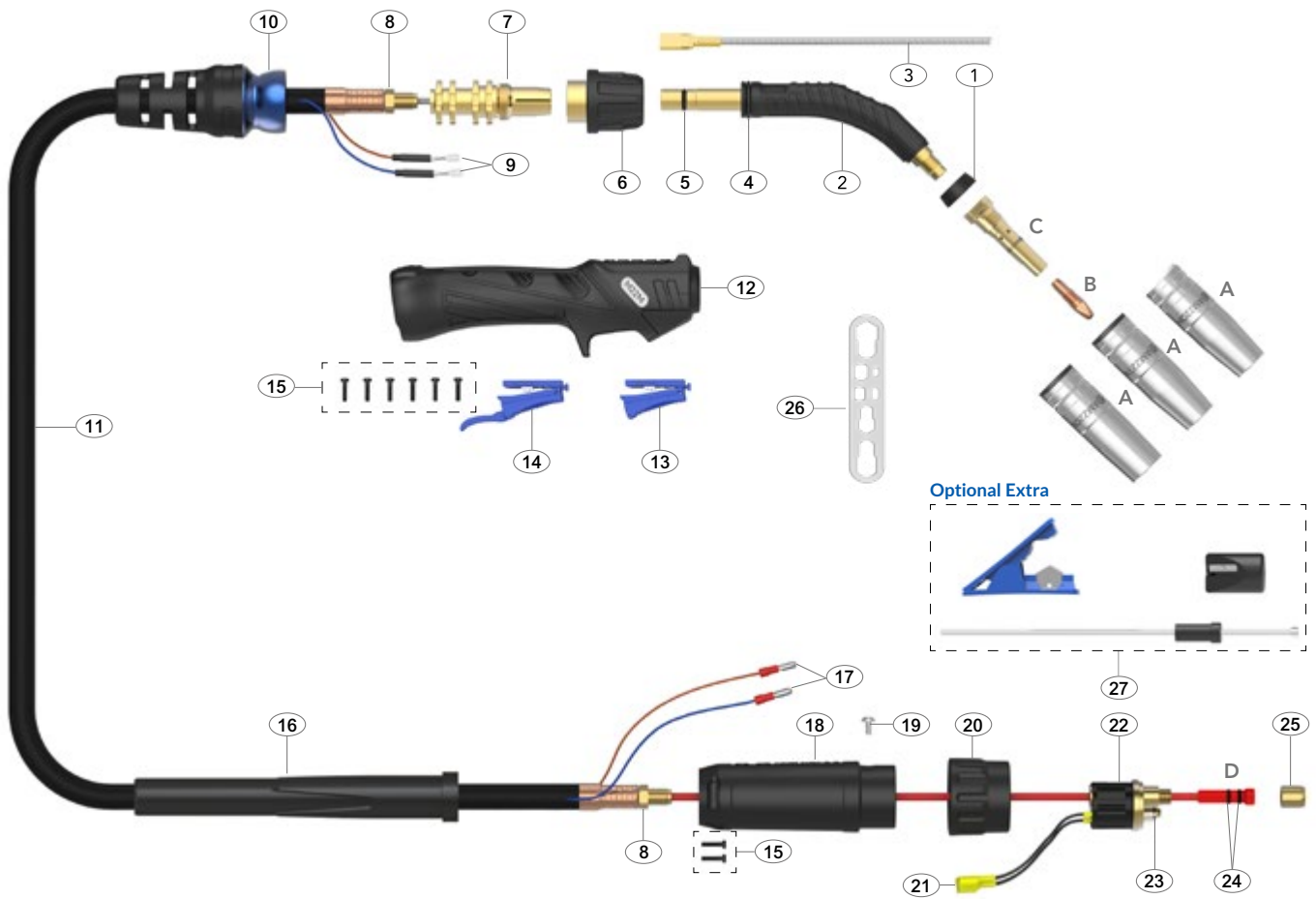

Spare Parts

Part Number	Description
1	AM2AP Neck Insulator
2	AM22001M Swan Neck Assembly - Multijust
3	AM22MJL Neck Jump Liner 0.8-1.2mm - Hard Wire
4	AM-MJ1509 Neck 'O' Ring(Ø14xØ2.5)
5	AM-MJ1508 Neck 'O' Ring(Ø8.5xØ1.5)
6	AM1516M Neck Nut - Multijust
7	AM1515M Socket Connection
8	AM1505 Lock Nut
9	AM1521 Cable Terminal
10	AM1514 Handle Cable Support c/w Ball Joint
11	AM2603-30 Ultraflex Cable Assembly x 3mt
	AM2603-40 Ultraflex Cable Assembly x 4mt
	AM2603-50 Ultraflex Cable Assembly x 5mt
12	AM2514 Handle Kit
13	AM2516 Microswitch Standard Trigger
14	AM2516L Microswitch Extended Trigger
15	AMSP1-1 Screw Pack
16	AMPA3541 Cable Support
17	AM1522 Cable Terminal Male
18	AM2578/L Gun Plug Housing
19	AML1541 Gun Plug Screw
20	AMC1519/S Gun Plug Nut
21	AM1523 Gun Plug Terminal Female

Part Number	Description
22	AM1528 Hybrid Gun Plug Body c/w Spring Pins
23	AM1524 Gun Plug 'O' Ring
24	AMLOR Liner 'O' Ring
25	AM1826 Liner Retaining Nut
26	AMWS Wear Parts Spanner
Optional Extra	
27	AMCLST-KITS Combi-Liner Set-up kit

Welding with Soft Wires

For welding with Aluminum wires use a Combi-liner (page 38). Optimum installation is achieved when using the Combi-liner set-up kit.

M3 ^{New} Air-Cooled Mig Welding Torch

Ratings:	300A CO ₂ , 270A mixed gas M21, EN60974-7 @ 60% duty cycle. 0.9mm-1.2mm wires
----------	---

The Arc M3 is a true 300 Amp Torch which outperforms all Binzel® MB36 derivatives and is ideal for 1.2mm production work.



ARC M HIGH PERFORMANCE MIG TORCH PACKAGES

M3 Torches are supplied with a Euro termination as standard and are supplied 'ready to weld' with all wear parts fitted.

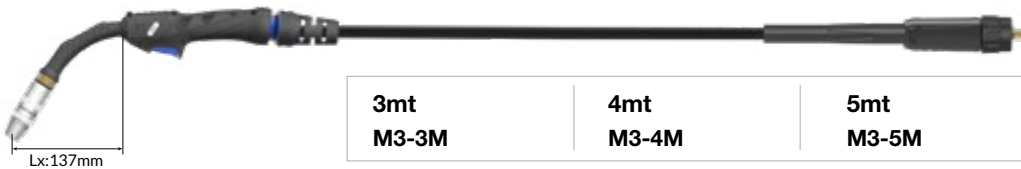

Wear Parts

Nozzles - 2 Piece

	Part Number	Description	Bore	Wall	Material
A	AM3HDTN	Tapered Nozzle (Part 2)	12mm	3mm	Copper
	•AM3HDCN	Conical Nozzle (Part 2)	14mm	3mm	Copper
	AM3HDCYN	Cylindrical Nozzle (Part 2)	19mm	3mm	Copper
A1	•AM3HDNI	Nozzle Insulator(Part 1)			Copper

Nozzles - Single Piece

A2	AM3TN	Tapered Nozzle / Insulator Assy	12mm	2.25mm	Copper
	AM3CN	Conical Nozzle / Insulator Assy	14mm	2.25mm	Copper
	AM3CYN	Cylindrical Nozzle / Insulator Assy	19mm	2.25mm	Copper

B Contact Tips

	Part Number	Description	Size (mm)	Wire Size (mm-inch)	Material
Standard Series					
	AM5CT09	Contact Tip	M8*29.5	0.9-0.035	CuCrZr
	AM5CT10	Contact Tip	M8*29.5	1.0-0.040	CuCrZr
	•AM5CT12	Contact Tip	M8*29.5	1.2-0.045	CuCrZr
A Series					
	AM5CT10A	Contact Tip	M8*29.5	1.0-0.040	CuCrZr
	AM5CT12A	Contact Tip	M8*29.5	1.2-0.045	CuCrZr
	AM2CT10A	Contact Tip	M8*29.5	1.0-0.040	Copper
	AM2CT12A	Contact Tip	M8*29.5	1.2-0.045	Copper

C Tip Adaptors

Part Number	Description	Material
•AM3TAB	Tip Adaptor	Brass
AM3TAC	Tip Adaptor High Performance	CuCrZr

D Liners

Part Number	Description	Wire Size
•AM2524-30	Steel Liner x 3mt	1.0-1.2mm
•AM2524-40	Steel Liner x 4mt	1.0-1.2mm
•AM2524-50	Steel Liner x 5mt	1.0-1.2mm
AM1535-30	Steel Liner x 3mt	0.6-0.9mm
AM1535-40	Steel Liner x 4mt	0.6-0.9mm
AM1535-50	Steel Liner x 5mt	0.6-0.9mm

•Denotes torch package standard wear part set-up

SuperSoft -20 Premium Power Cables
Perfect for extreme subzero working conditions

® All Trademarks are the property of their respective owners and usage is for cross reference only

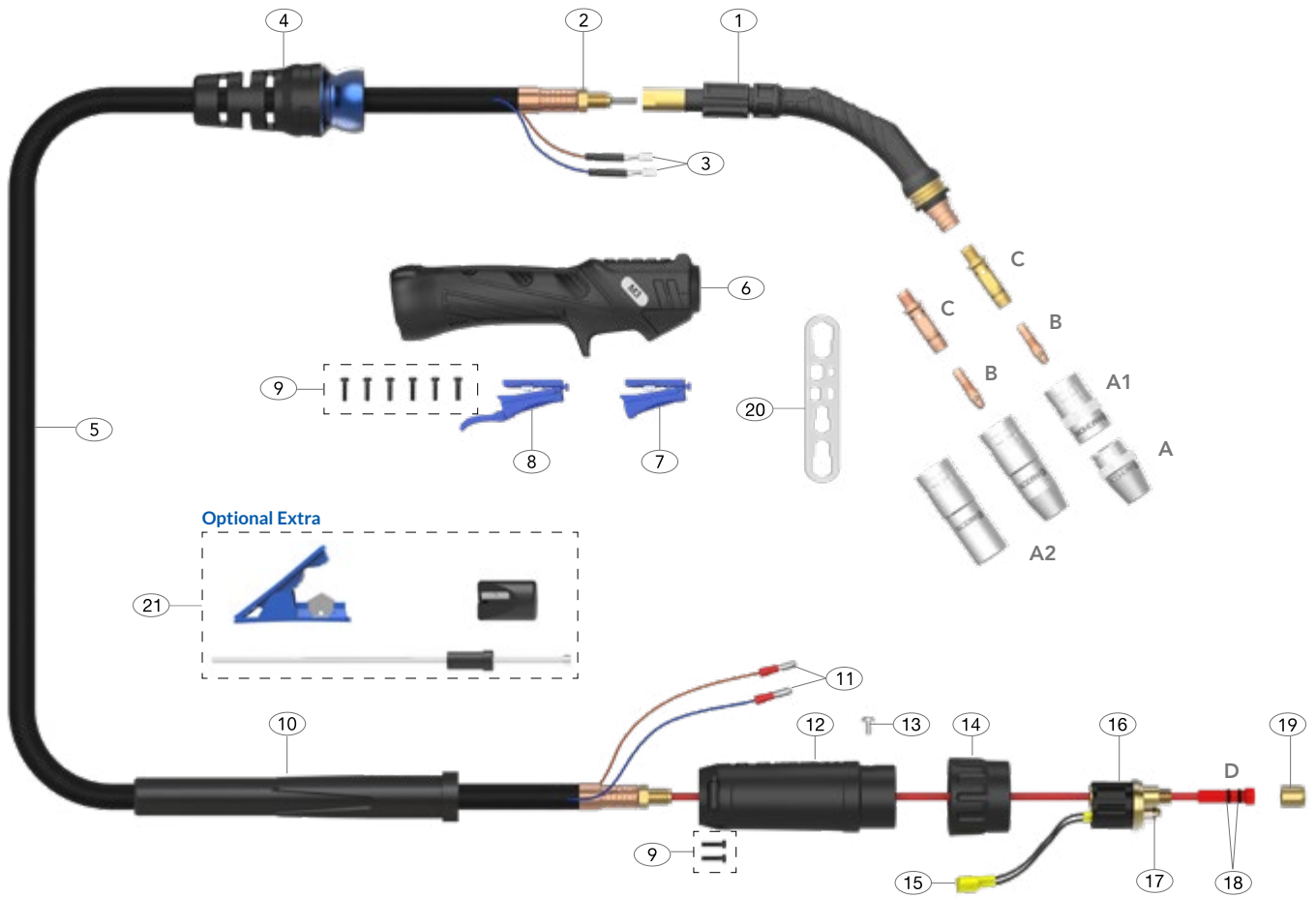

Spare Parts

Part Number	Description
1 AM3001	Swan Neck Assembly
2 AM1505	Lock Nut
3 AM1521	Cable Terminal
4 AM1514	Handle Cable Support c/w Ball Joint
5 AM3003CW-30	Power Cable Assembly x 3mt
AM3003CW-40	Power Cable Assembly x 4mt
AM3003CW-50	Power Cable Assembly x 5mt
6 AM2514	Handle Kit
7 AM2516	Microswitch Standard Trigger
8 AM2516L	Microswitch Extended Trigger
9 AMSP1-1	Screw Pack
10 AMPA3541	Cable Support
11 AM1522	Cable Terminal Male
12 AM2578/L	Gun Plug Housing
13 AML1541	Gun Plug Screw
14 AMC1519	Gun Plug Nut
15 AM1523	Gun Plug Terminal Female

Part Number	Description
16 AM1528	Hybrid Gun Plug Body c/w Spring Pins
17 AM1524	Gun Plug 'O' Ring
18 AMLOR	Liner 'O' Ring
19 AM1826	Liner Retaining Nut
20 AMWS	Wear Parts Spanner
Optional Extra	
21 AMCLST-KITS	Combi-Liner Set-up kit

Welding with Soft Wires

For welding with Aluminum wires use a Combi-liner (page 47). Optimum installation is achieved when using the Combi-liner set-up kit.

M4 ^{New} Air-Cooled Mig Welding Torch



Ratings:	350A CO ₂ , 320A mixed gas M21, EN60974-7 @ 60% duty cycle. 0.9mm-1.2mm wires
----------	---

The Arc M4 performance is superior to the Binzel® MB36 and delivers more power than an MB38.

An all-day production torch in solid wire and pulse Mig applications over 300 Amps.

ARC M HIGH PERFORMANCE MIG TORCH PACKAGES

M4 Torches are supplied with a Euro termination as standard and are supplied 'ready to weld' with all wear parts fitted.



Wear Parts

Nozzles - 2 Piece

	Part Number	Description	Bore	Wall	Material
A	AM4HDTN	Tapered Nozzle (Part 2)	13mm	3mm	Copper
	•AM4HDCN	Conical Nozzle (Part 2)	15mm	3mm	Copper
	AM4HDCYN	Cylindrical Nozzle (Part 2)	21mm	3mm	Copper
A1	•AM4HDNI	Nozzle Insulator (Part 1)			Copper

Nozzles - Single Piece

	Part Number	Description	Bore	Wall	Material
A2	AM4TN	Tapered Nozzle / Insulator Assy	13mm	2.25mm	Copper
	AM4CN	Conical Nozzle / Insulator Assy	15mm	2.25mm	Copper
	AM4CYN	Cylindrical Nozzle / Insulator Assy	21mm	2.25mm	Copper

B Contact Tips

Part Number	Description	Size (mm)	Wire Size (mm-inch)	Material
Standard Series				
AM6WCT09	Contact Tip	M10*35.5	0.9 - 0.035	CuCrZr
AM6WCT10	Contact Tip	M10*35.5	1.0 - 0.040	CuCrZr
•AM6WCT12	Contact Tip	M10*35.5	1.2 - 0.045	CuCrZr
A Series				
AM6WCT10A	Contact Tip	M10*35.5	1.0 - 0.040	CuCrZr
AM6WCT12A	Contact Tip	M10*35.5	1.2 - 0.045	CuCrZr
AMC6WCT10A	Contact Tip	M10*35.5	1.0 - 0.040	Copper
AMC6WCT12A	Contact Tip	M10*35.5	1.2 - 0.045	Copper

C Tip Adaptors

Part Number	Description	Material
•AM4TAB	Tip Adaptor	Brass
AM4TAC	Tip Adaptor High Performance	CuCrZr

D Liners

Part Number	Description	Wire Size
•AM2524-30	Steel Liner x 3mt	1.0-1.2mm
•AM2524-40	Steel Liner x 4mt	1.0-1.2mm
•AM2524-50	Steel Liner x 5mt	1.0-1.2mm
AM1535-30	Steel Liner x 3mt	0.6-0.9mm
AM1535-40	Steel Liner x 4mt	0.6-0.9mm
AM1535-50	Steel Liner x 5mt	0.6-0.9mm

•Denotes torch package standard wear part set-up

SuperSoft -20 Premium Power Cables
Perfect for extreme subzero working conditions

® All Trademarks are the property of their respective owners and usage is for cross reference only

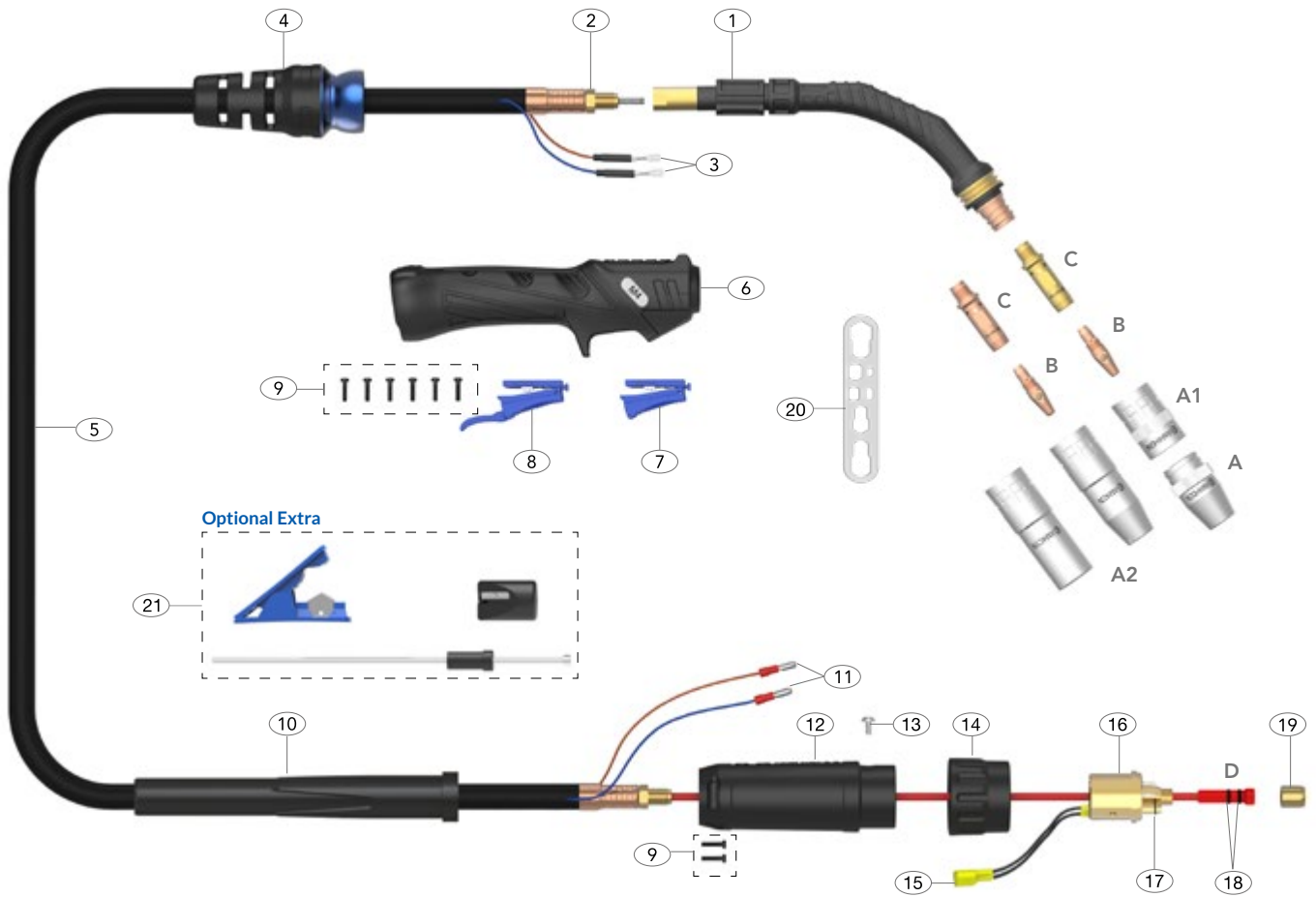

Spare Parts

Part Number	Description
1 AM4001	Swan Neck Assembly
2 AM1505	Lock Nut
3 AM1521	Cable Terminal
4 AM1514	Handle Cable Support c/w Ball Joint
5 AM4003CW-30 AM4003CW-40 AM4003CW-50	Power Cable Assembly x 3mt Power Cable Assembly x 4mt Power Cable Assembly x 5mt
6 AM2514	Handle Kit
7 AM2516	Microswitch Standard Trigger
8 AM2516L	Microswitch Extended Trigger
9 AMSP1-1	Screw Pack
10 AMPA3541	Cable Support
11 AM1522	Cable Terminal Male
12 AM2578/L	Gun Plug Housing
13 AM1526	Gun Plug Screw
14 AMC1519	Gun Plug Nut
15 AM1523	Gun Plug Terminal Female

Part Number	Description
16 AMB1528S	Gun Plug Body c/w Spring Pins
17 AM1524	Gun Plug 'O' Ring
18 AMLOR	Liner 'O' Ring
19 AM1826	Liner Retaining Nut
20 AMWS	Wear Parts Spanner
Optional Extra	
21 AMCLST-KITS	Combi-Liner Set-up kit

Welding with Soft Wires

For welding with Aluminum wires use a Combi-liner (page 47). Optimum installation is achieved when using the Combi-liner set-up kit.

M5 ^{New} Air-Cooled Mig Welding Torch

Ratings:	390A CO ₂ , 360A mixed gas M21, EN60974-7 @ 60% duty cycle. 0.9mm-1.6mm wires
----------	---

Constructed for power, performance, and longevity the M5 is ideal for heavy duty 1.2mm and 1.6mm high deposition and pulse applications. A retrofit heat shield is available for high reflected heat applications.



M5 Video

ARC M HIGH PERFORMANCE MIG TORCH PACKAGES

M5 Torches are supplied with a Euro termination as standard and are supplied 'ready to weld' with all wear parts fitted.

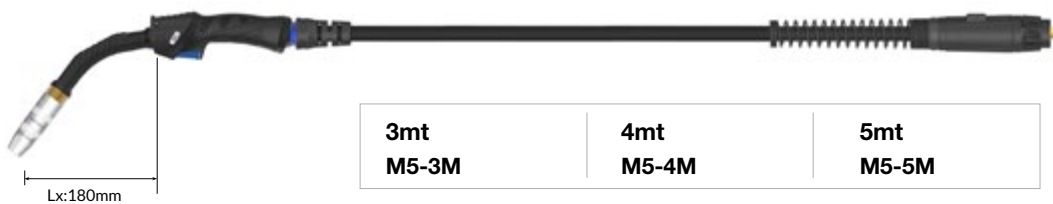

Wear Parts

Nozzle - 2 Piece

Part Number	Description	Bore	Wall	Material
A AM5HDTN	Tapered Nozzle- (Part 2)	13mm	3.5mm	Copper
•AM5HDCN	Conical Nozzle - (Part 2)	15mm	3.5mm	Copper
AM5HDCYN	Cylindrical Nozzle - (Part 2)	21mm	3.5mm	Copper
A1•AM5HDNI	Nozzle Insulator- (Part 1)			Copper

Nozzle - Single Piece

A2 AM5TN	Tapered Nozzle / Insulator Assy	13mm	2.5mm	Copper
AM5CN	Conical Nozzle / Insulator Assy	15mm	2.5mm	Copper
AM5CYN	Cylindrical Nozzle / Insulator Assy	21mm	2.5mm	Copper

B Contact Tips

Part Number	Description	Size (mm)	Wire Size (mm-inch)	Material
Standard Series				
AM6WCT09	Contact Tip	M10*35.5	0.9 - 0.035	CuCrZr
AM6WCT10	Contact Tip	M10*35.5	1.0 - 0.040	CuCrZr
•AM6WCT12	Contact Tip	M10*35.5	1.2 - 0.045	CuCrZr
AM6WCT14	Contact Tip	M10*35.5	1.4 - 0.055	CuCrZr
AM6WCT16	Contact Tip	M10*35.5	1.6 - 0.063	CuCrZr
AM6WCT20	Contact Tip	M10*35.5	2.0 - 0.080	CuCrZr
A Series				
AM6WCT10A	Contact Tip	M10*35.5	1.0 - 0.040	CuCrZr
AM6WCT12A	Contact Tip	M10*35.5	1.2 - 0.045	CuCrZr
AM6WCT16A	Contact Tip	M10*35.5	1.6 - 0.063	CuCrZr
AMC6WCT10A	Contact Tip	M10*35.5	1.0 - 0.040	Copper
AMC6WCT12A	Contact Tip	M10*35.5	1.2 - 0.045	Copper

Tip Adaptors

Part Number	Description	Material
AM5TAC	Tip Adaptor High Performance	CuCrZr
•AM5TAB	Tip Adaptor	Brass

D Liners

Part Number	Description	Wire Size
•AM6SL-1012-30	Steel Liner x 3mt	1.0-1.2mm
•AM6SL-1012-40	Steel Liner x 4mt	1.0-1.2mm
•AM6SL-1012-50	Steel Liner x 5mt	1.0-1.2mm
AM6SL-16-30	Steel Liner x 3mt	1.6mm
AM6SL-16-40	Steel Liner x 4mt	1.6mm
AM6SL-16-50	Steel Liner x 5mt	1.6mm

• Denotes torch package standard wear part set-up

SuperSoft -20 Premium Power Cables
Perfect for extreme subzero working conditions

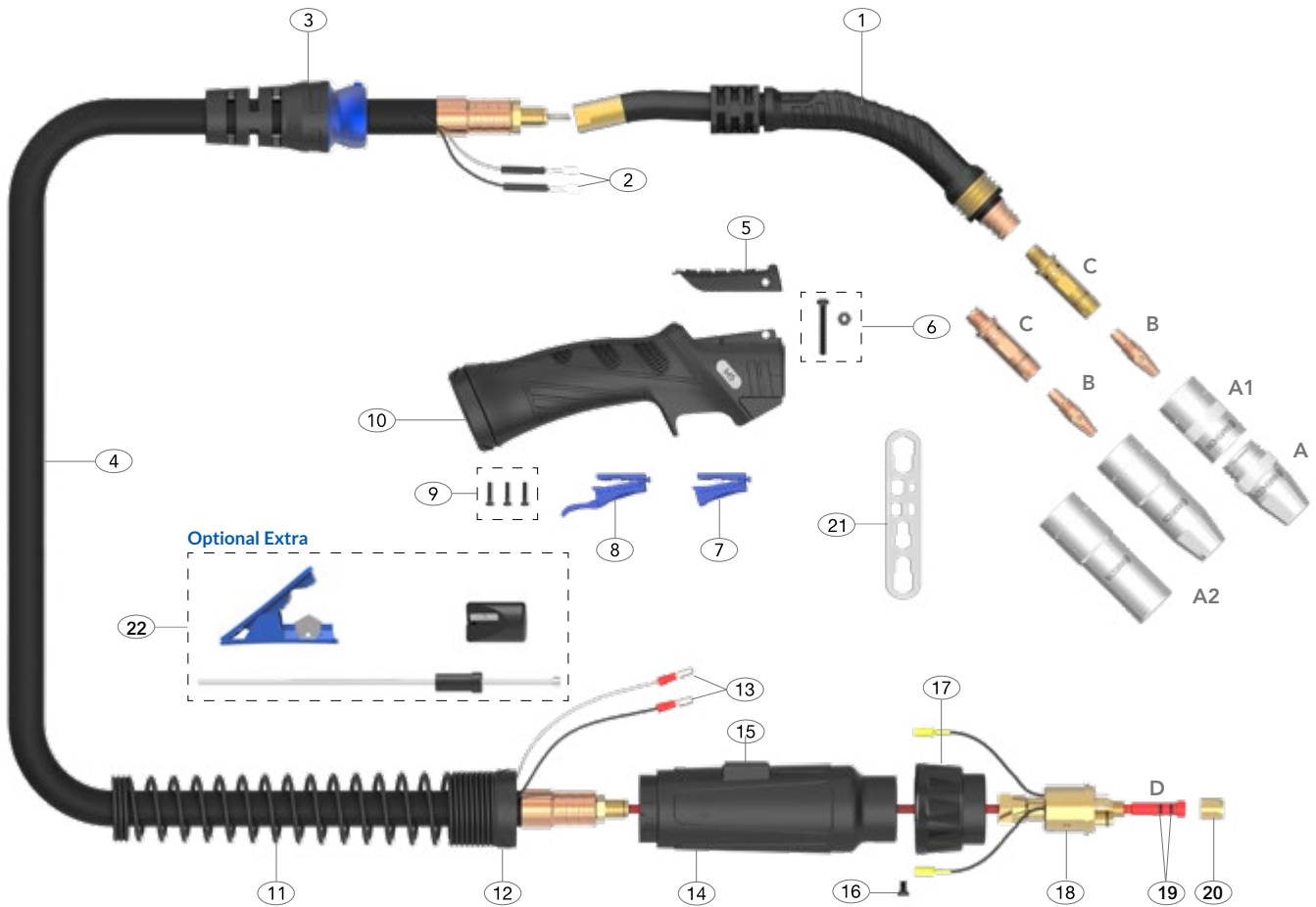

Spare Parts

Part Number	Description
1	AM5001 Swan Neck Assembly
2	AM1521 Cable Terminal
3	AMS8017 Handle Cable Support c/w Ball Joint
4	AM5003CW-30 Power Cable Assembly x 3mt AM5003CW-40 Power Cable Assembly x 4mt AM5003CW-50 Power Cable Assembly x 5mt
5	AM2515-C Handle Control Cover
6	AMDMS Screw and Nut
7	AM2516 Microswitch Standard Trigger
8	AM2516L Microswitch Extended Trigger
9	AMSP1-1 Screw Pack
10	AM2515 Handle and Lock Nut Assembly
11	AM8026 Housing Spring
12	AM8028 Housing Lock Nut
13	AM1522 Cable Terminal Male

Part Number	Description
14	AMT5022 Gun Plug Housing
15	AMF8017 Large Housing Flat Cover Block
16	AM1526 Gun Plug Screw
17	AM1519 Gun Plug Nut
18	AMB1528 Gun Plug Body
19	AMLOR Liner 'O' Ring
20	AM1826 Liner Retaining Nut
21	AMWS Wear Parts Spanner
Optional Extra	
22	AMCLST-KITS Combi-Liner Set-up kit

Welding with Soft Wires

For welding with Aluminum wires use a Combi-liner (page 47-48). Optimum installation is achieved when using the Combi-liner set-up kit.

M6 ^{New} Air-Cooled Mig Welding Torch

Ratings:	430A CO ₂ , 400A mixed gas M21, EN60974-7 @ 60% duty cycle. 0.9mm-2.0mm wires
----------	---

An Indestructible 400 Amp Air-Cooled Production Torch.
Perfect for high amps, high deposition, pulse, and high duty applications with 1.2mm and 1.6mm wires.
A retrofit heat shield is available for high reflected heat applications.

ARC M HIGH PERFORMANCE MIG TORCH PACKAGES

M6 Torches are supplied with a Euro termination as standard and are supplied 'ready to weld' with all wear parts fitted.

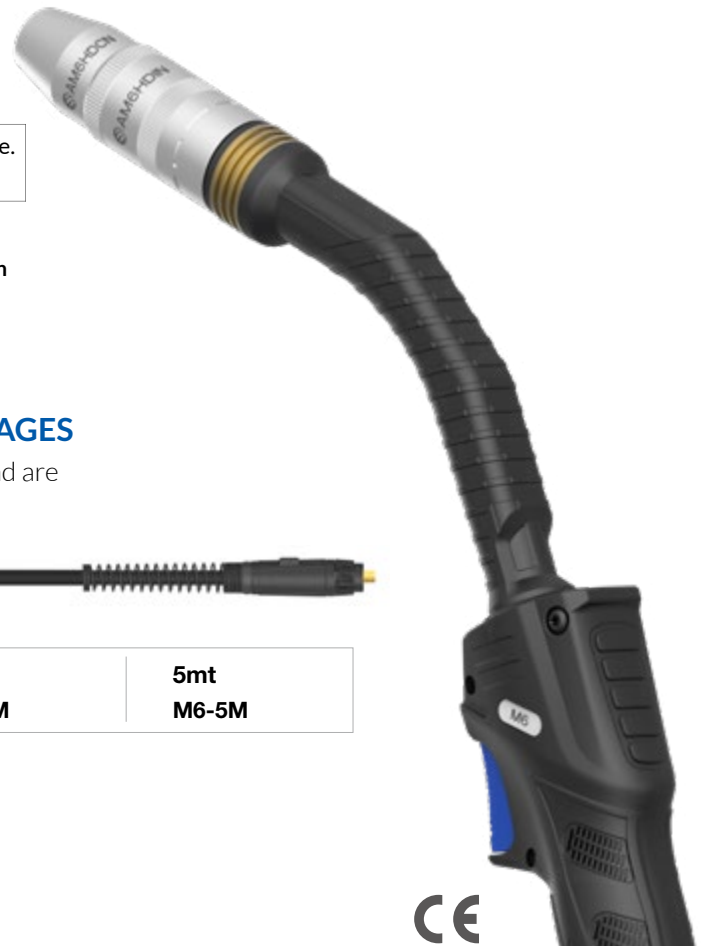
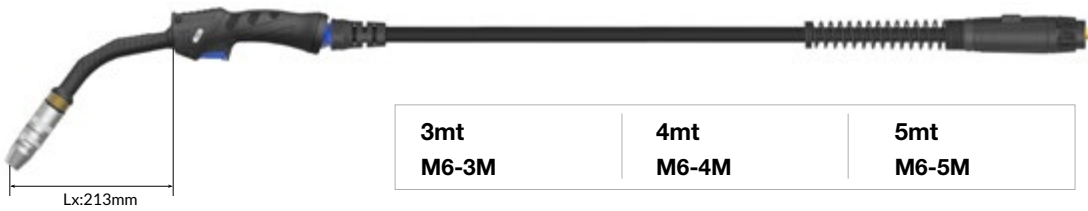

Wear Parts

Nozzle - 2 Piece

Part Number	Description	Bore	Wall	Material
A AM6HDTN	Tapered Nozzle (Part 2)	13mm	3.5mm	Copper
•AM6HDCN	Conica Nozzle (Part 2)	15mm	3.5mm	Copper
AM6HDCYN	Cylindrical Nozzle (Part 2)	23mm	3.5mm	Copper
A1•AM6HDNI	Nozzle Insulator(Part 1)			Copper

Nozzle - Single Piece

A2 AM6TN	Tapered Nozzle / Insulator Assy	13mm	2.5mm	Copper
AM6CN	Conical Nozzle / Insulator Assy	15mm	2.5mm	Copper
AM6CYN	Cylindrical Nozzle / Insulator Assy	23mm	2.5mm	Copper

B Contact Tips

Part Number	Description	Size (mm)	Wire Size (mm-inch)	Material
Standard Series				
AM6CT09	Contact Tip	M12*40.5	0.9 - 0.035	CuCrZr
AM6CT10	Contact Tip	M12*40.5	1.0 - 0.040	CuCrZr
•AM6CT12	Contact Tip	M12*40.5	1.2 - 0.045	CuCrZr
AM6CT14	Contact Tip	M12*40.5	1.4 - 0.055	CuCrZr
AM6CT16	Contact Tip	M12*40.5	1.6 - 0.063	CuCrZr
AM6CT20	Contact Tip	M12*40.5	2.0 - 0.080	CuCrZr
A Series				
AM6CT10A	Contact Tip	M12*40.5	1.0 - 0.040	CuCrZr
AM6CT12A	Contact Tip	M12*40.5	1.2 - 0.045	CuCrZr
AM6CT16A	Contact Tip	M12*40.5	1.6 - 0.063	CuCrZr
AM6CT20A	Contact Tip	M12*40.5	2.0 - 0.080	CuCrZr
AMC6CT10A	Contact Tip	M12*40.5	1.0 - 0.040	Copper
AMC6CT12A	Contact Tip	M12*40.5	1.2 - 0.045	Copper

C Tip Adaptors

Part Number	Description	Material
•AM6TAC	Tip Adaptor High Performance	CuCrZr
AM6TAB	Tip Adaptor	Brass

D Liners

Part Number	Description	Wire Size
•AM6SL-1012-30	Steel Liner x 3mt	1.0-1.2mm
•AM6SL-1012-40	Steel Liner x 4mt	1.0-1.2mm
•AM6SL-1012-50	Steel Liner x 5mt	1.0-1.2mm
AM6SL-16-30	Steel Liner x 3mt	1.6mm
AM6SL-16-40	Steel Liner x 4mt	1.6mm
AM6SL-16-50	Steel Liner x 5mt	1.6mm

• Denotes torch package standard wear part set-up

SuperSoft -20 Premium Power Cables
 Perfect for extreme subzero working conditions

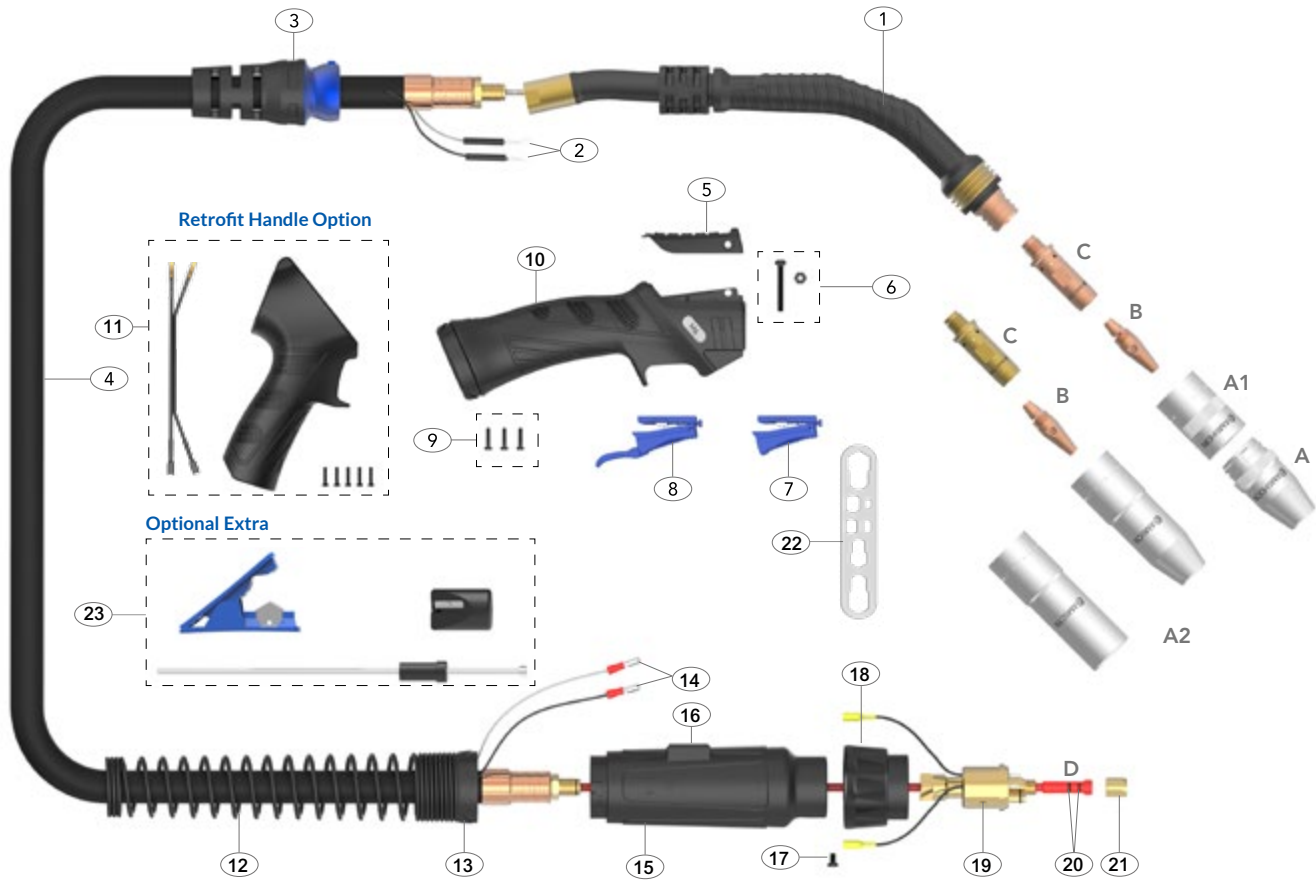

Spare Parts

Part Number	Description
1 AM6001	Swan Neck Assembly
2 AM1521	Cable Terminal
3 AMS8017	Handle Cable Support c/w Ball Joint
4 AM6003CW-30	Power Cable Assembly x 3mt
AM6003CW-40	Power Cable Assembly x 4mt
AM6003CW-50	Power Cable Assembly x 5mt
5 AM2515-C	Handle Control Cover
6 AMDMNS	Screw and Nut
7 AM2516	Microswitch Standard Trigger
8 AM2516L	Microswitch Extended Trigger
9 AMSP1-1	Screw Pack
10 AM2515	Handle and Lock Nut Assembly
12 AM8026	Housing Spring
13 AM8028	Housing Lock Nut
14 AM1522	Cable Terminal Male
15 AMT5022	Gun Plug Housing
16 AMF8017	Large Housing Wire Cover
17 AM1526	Gun Plug Screw
18 AM1519	Gun Plug Nut
19 AMB1528	Gun Plug Body
20 AMLOR	Liner 'O' Ring

Part Number	Description
21 AM1826	Liner Retaining Nut
22 AMWS	Wear Parts Spanner
Optional Extra	
23 AMCLST-KITS	Combi-Liner Set-up kit

Retrofit Handle Option

Part Number	Description
11 AMMP2515	Pistol Handle Assembly

Welding with Soft Wires

For welding with Aluminum wires use a Combi-liner (page 47-48). Optimum installation is achieved when using the Combi-liner set-up kit.

M5W Liquid-Cooled Mig Welding Torch

Ratings:	560A CO ₂ , 540A mixed gas M21, 380A pulse @100% Max. Load 24KW with 1600W liquid cooler, 0.9mm-1.6mm wires
	540A CO ₂ , 520A mixed gas M21, 350A pulse @100% Max. Load 22KW with 1200W liquid cooler, 0.9mm-1.6mm wires

Ideal for heavy duty 1.2mm high deposition and pulse applications with all wire types



M5W Video

Compact Handle

ARC M HIGH PERFORMANCE MIG TORCH PACKAGES

M5W Torches are supplied with a Euro termination as standard and are supplied 'ready to weld' with all wear parts fitted.

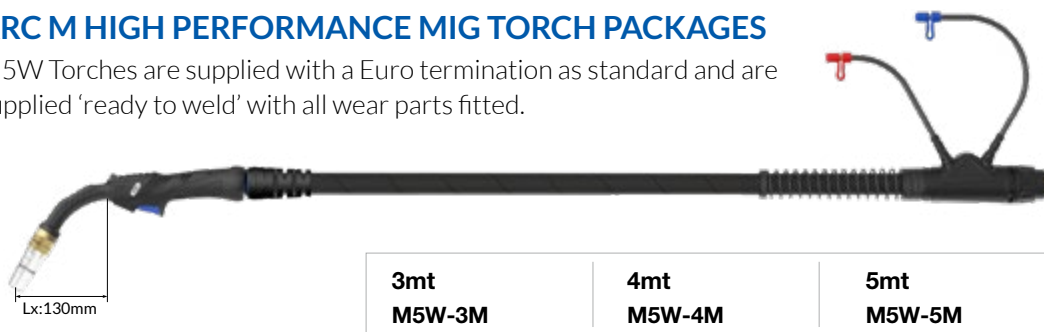

3mt M5W-3M	4mt M5W-4M	5mt M5W-5M
-----------------------------	-----------------------------	-----------------------------



Wear Parts

Nozzles

Part Number	Description	Bore	Wall	Material
A •AMN5WCN	Conical / Insulator Assy	13.5mm	3.0mm	Copper
AMN5WTN	Tapered / Insulator Assy	11.5mm	3.0mm	Copper
AMN5WCYN	Cylindrical / Insulator Assy	16.0mm	3.0mm	Copper
A1•AMN5WCN-C	Conical Nozzle c/w Insulator & Retaining Ring			
AMN5WTN-C	Tapered Nozzle c/w Insulator & Retaining Ring			
AMN5WCYN-C	Cylindrical Nozzle c/w Insulator & Retaining Ring			

B Nozzle Retaining Rings

Part Number	Description	Size	Material
•AMN5WCNR	Nozzle Retaining Ring	29.5mm	Brass

C Contact Tips

Part Number	Description	Size (mm)	Wire Size (mm-inch)	Material
Standard Series				
AM5CT09	Contact Tip	M8*29.5	0.9 - 0.035	CuCrZr
AM5CT10	Contact Tip	M8*29.5	1.0 - 0.040	CuCrZr
•AM5CT12	Contact Tip	M8*29.5	1.2 - 0.045	CuCrZr
AM5CT14	Contact Tip	M8*29.5	1.4 - 0.055	CuCrZr
AM5CT16	Contact Tip	M8*29.5	1.6 - 0.063	CuCrZr
A Series				
AM5CT10A	Contact Tip	M8*29.5	1.0 - 0.040	CuCrZr
AM5CT12A	Contact Tip	M8*29.5	1.2 - 0.045	CuCrZr
AM5CT16A	Contact Tip	M8*29.5	1.6 - 0.063	CuCrZr
AM2CT10A	Contact Tip	M8*29.5	1.0 - 0.040	Copper
AM2CT12A	Contact Tip	M8*29.5	1.2 - 0.045	Copper

•Denotes torch package standard wear part set-up

D Tip Adaptors

Part Number	Description	Material
•AM5WTAC-20	High Performance 2.0mm Recess	Copper
AM5WTAC-45	High Performance 4.5mm Recess	Copper
AM5WTAB-20	Tip Adaptor 2.0mm Recess	Brass
AM5WTAB-45	Tip Adaptor 4.5mm Recess	Brass

E Tip Adaptor Insulators

Part Number	Description
•AM5WTAI	Tip Adaptor Insulator

F Liners

Part Number	Description	Wire Size
•AM6SL-1012-30	Steel Liner x 3mt	1.0-1.2mm
•AM6SL-1012-40	Steel Liner x 4mt	1.0-1.2mm
•AM6SL-1012-50	Steel Liner x 5mt	1.0-1.2mm
AM6SL-16-30	Steel Liner x 3mt	1.6mm
AM6SL-16-40	Steel Liner x 4mt	1.6mm
AM6SL-16-50	Steel Liner x 5mt	1.6mm
AM6OSWL-1012-30	Soft Wire Liner x 3mt	1.0-1.2mm
AM6OSWL-1012-40	Soft Wire Liner x 4mt	1.0-1.2mm
AM6OSWL-1620-30	Soft Wire Liner x 3mt	1.6-2.0mm
AM6OSWL-1620-40	Soft Wire Liner x 4mt	1.6-2.0mm

For alternate liner options please refer to page 46-48

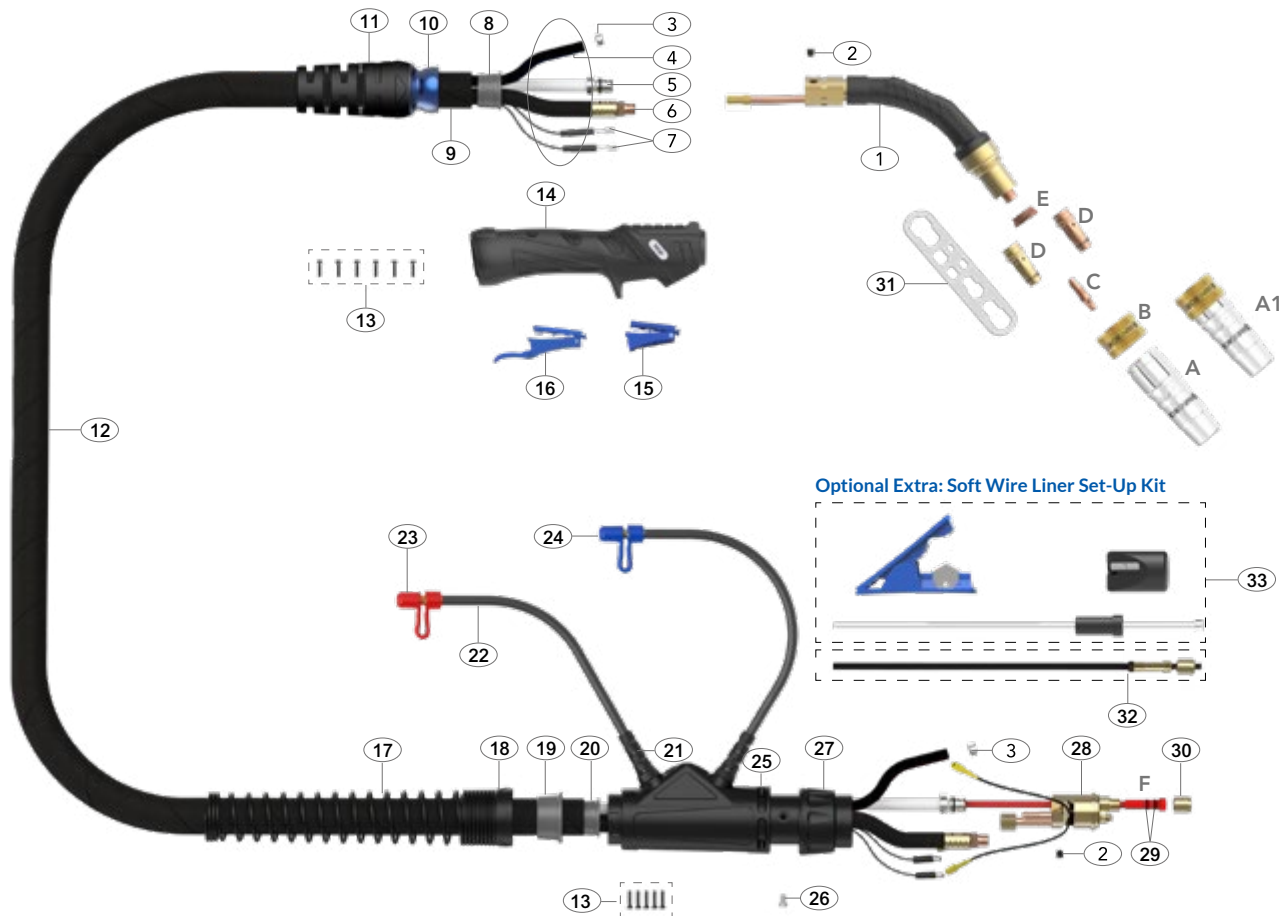

Spare Parts

Part Number	Description
1	AM5002 Swan Neck Assembly
2	AM6X5 Outer Liner Retaining Screw
3	AM15400023 Water Hose Clamp 10mm
8	AMS8010 Canvas Cover Retainer
10	AMS3208-1 Ball Joint
11	AMS3208-S Cable Support With Nut
13	AMSP1-1 Screw Pack
14	AMM2514 Handle Kit
15	AM2516 Microswitch Standard Trigger
16	AM2516L Microswitch Extended Trigger
17	AM8027 Cable Support Spring
18	AM8028 Housing Lock Nut
19	AM8009 Canvas Cover Clamp
20	AM8010 Canvas Cover Retainer
21	AM1820 Hose Support
22	AM5017 Water Outlet Hose Assembly
23	AM80320 Red Cap Stopper
24	AM80310 Blue Cap Stopper
25	AM5022 Housing Assembly
26	AM1526 Gun Plug Screw (M4 x 0.7)
27	AM1519 Gun Plug Nut
28	AM5098 Water-Cooled Plug Body Assembly
29	AMLOR Liner 'O' Ring
30	AM1826 Liner Retaining Nut
31	AMWS Wear Parts Spanner

Part Number	Description
Optional Extra	
32	AMOSWLG Soft Wire Liner Gasket
33	AMOSW-LINER-T Soft Wire / Combi-Liner Set-up Kit

Cable Parts

Description	Part Number		
	3mt	4mt	5mt
4 Water Inlet Hose Assembly	AM5012-30	AM5012-40	AM5012-50
5 Outer Liner Assembly	AM6008-30	AM6008-40	AM6008-50
6 Power Cable Assembly	AM6015-30	AM6015-40	AM6015-50
7 Switch Lead Assembly	AM5010-30	AM5010-40	AM5010-50
9 Canvas Cover Assembly	AM5019-30	AM5019-40	AM5019-50
12 Complete Cable Assembly	AM5506-30	AM5506-40	AM5506-50

Welding with Soft Wires

For welding with Aluminum wires use a Soft Wire / Combi-Liner (page 47-48). Optimum installation is achieved when using the Soft Wire / Combi-Liner set-up kit.

M55W Liquid-Cooled Mig Welding Torch

Ratings:	580A CO ₂ , 560A mixed gas M21, 400A pulse @100% Max. Load 25KW with 1600W liquid cooler, 0.9mm-2.0mm wires
	550A CO ₂ , 530A mixed gas M21, 360A pulse @100% Max. Load 23KW with 1200W liquid cooler, 0.9mm-2.0mm wires

Ideal for all high deposition applications with high reflected heat

ARC M HIGH PERFORMANCE MIG TORCH PACKAGES

M55W Torches are supplied with a Euro termination as standard and are supplied 'ready to weld' with an M10 set-up.

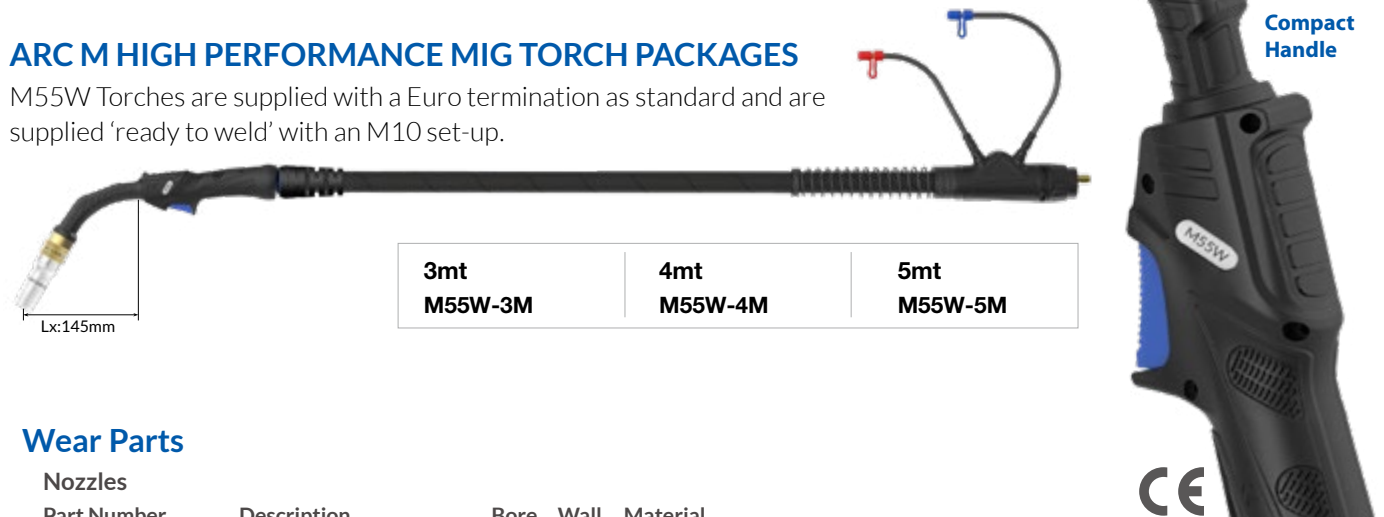

3mt M55W-3M	4mt M55W-4M	5mt M55W-5M
------------------------------	------------------------------	------------------------------

Wear Parts

Nozzles

Part Number	Description	Bore	Wall	Material
A •AMN55WCN	Conical / Insulator Assy	15mm	3.0mm	Copper
AMN55WTN	Tapered / Insulator Assy	13mm	3.0mm	Copper
AMN55WCYN	Cylindrical/Insulator Assy	17mm	3.0mm	Copper
A1•AMN55WCN-C	Conical Nozzle c/w Insulator & Retaining Ring			
AMN55WTN-C	Tapered Nozzle c/w Insulator & Retaining Ring			
AMN55WCYN-C	Cylindrical Nozzle c/w Insulator & Retaining Ring			

B Nozzle Retaining Rings

Part Number	Description	Size	Material
•AMN6WCNR	Nozzle Retaining Ring-Pull Off	30.5mm	Brass

C Contact Tips

Part Number	Description	Size (mm)	Wire Size (mm-inch)	Material
Standard Series				
AM6WCT09	Contact Tip	M10*35.5	0.9 - 0.035	CuCrZr
AM6WCT10	Contact Tip	M10*35.5	1.0 - 0.040	CuCrZr
•AM6WCT12	Contact Tip	M10*35.5	1.2 - 0.045	CuCrZr
AM6WCT14	Contact Tip	M10*35.5	1.4 - 0.055	CuCrZr
AM6WCT16	Contact Tip	M10*35.5	1.6 - 0.063	CuCrZr
AM6WCT20	Contact Tip	M10*35.5	2.0 - 0.080	CuCrZr
A Series				
AM6WCT10A	Contact Tip	M10*35.5	1.0 - 0.040	CuCrZr
AM6WCT12A	Contact Tip	M10*35.5	1.2 - 0.045	CuCrZr
AM6WCT16A	Contact Tip	M10*35.5	1.6 - 0.063	CuCrZr
AM6WCT20A	Contact Tip	M10*35.5	2.0 - 0.080	CuCrZr
AMC6WCT10A	Contact Tip	M10*35.5	1.0 - 0.040	Copper
AMC6WCT12A	Contact Tip	M10*35.5	1.2 - 0.045	Copper

• Denotes torch package standard wear part set-up

D Tip Adaptors

Part Number	Description	Material
•AM6OSWTAC-20	High Performance 2.0mm Recess	Copper
AM6OSWTAC-45	High Performance 4.5mm Recess	Copper
AM6OSWTAB-20	Tip Adaptor 2.0mm Recess	Brass
AM6OSWTAB-45	Tip Adaptor 4.5mm Recess	Brass

E Tip Adaptor Insulators

Part Number	Description
•AM55WTAI	Tip Adaptor Insulator

F Liners

Part Number	Description	Wire Size
•AM6SL-1012-30	Steel Liner x 3mt	1.0-1.2mm
•AM6SL-1012-40	Steel Liner x 4mt	1.0-1.2mm
•AM6SL-1012-50	Steel Liner x 5mt	1.0-1.2mm
AM6SL-16-30	Steel Liner x 3mt	1.6mm
AM6SL-16-40	Steel Liner x 4mt	1.6mm
AM6SL-16-50	Steel Liner x 5mt	1.6mm
AM6SL-20-30	Steel Liner x 3mt	2.0mm
AM6SL-20-40	Steel Liner x 4mt	2.0mm
AM6SL-20-50	Steel Liner x 5mt	2.0mm
AM6OSWL-1012-30	Soft Wire Liner x 3mt	1.0-1.2mm
AM6OSWL-1012-40	Soft Wire Liner x 4mt	1.0-1.2mm
AM6OSWL-1620-30	Soft Wire Liner x 3mt	1.6-2.0mm
AM6OSWL-1620-40	Soft Wire Liner x 4mt	1.6-2.0mm

For alternate liner options please refer to page 46-48

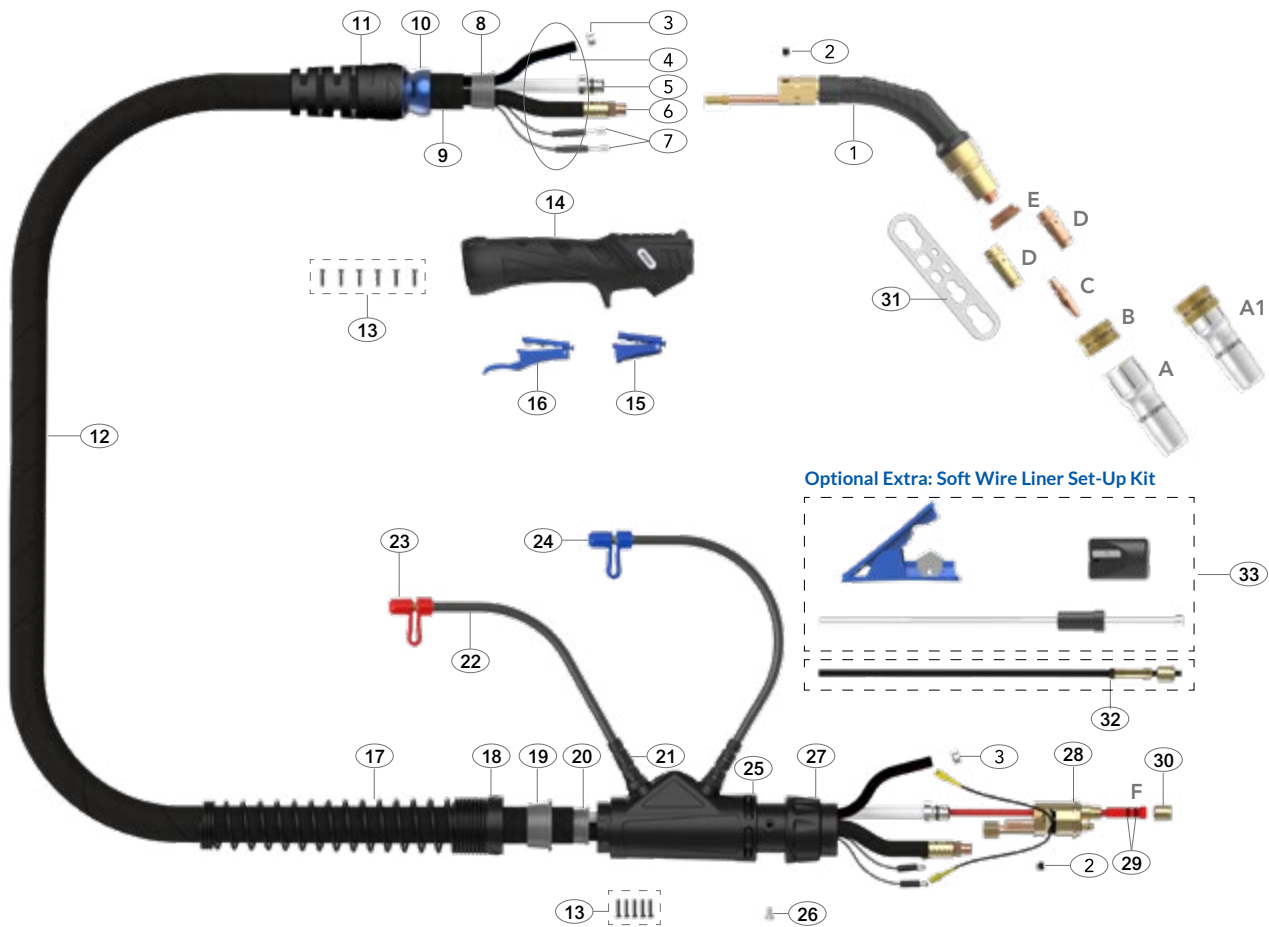

Spare Parts

Part Number	Description	
1	AM5502	Swan Neck Assembly
2	AM6X5	Outer Liner Retaining Screw
3	AM15400023	Water Hose Clamp 10mm
8	AMS8010	Canvas Cover Retainer
10	AMS3208-1	Ball Joint
11	AMS3208-S	Cable Support With Nut
13	AMSP1-1	Screw Pack
14	AMM2514	Handle Kit
15	AM2516	Microswitch Standard Trigger
16	AM2516L	Microswitch Extended Trigger
17	AM8027	Cable Support Spring
18	AM8028	Housing Lock Nut
19	AM8009	Canvas Cover Clamp
20	AM8010	Canvas Cover Retainer
21	AM1820	Hose Support
22	AM5017	Water Outlet Hose Assembly
23	AM80320	Red Cap Stopper
24	AM80310	Blue Cap Stopper
25	AM5022	Housing Assembly
26	AM1526	Gun Plug Screw (M4 x 0.7)
27	AM1519	Gun Plug Nut
28	AM5098	Water-Cooled Plug Body Assembly
29	AMLOR	Liner 'O' Ring
30	AM1826	Liner Retaining Nut
31	AMWS	Wear Parts Spanner

Part Number	Description	
Optional Extra		
32	AMOSWLG	Soft Wire Liner Gasket
33	AMOSW-LINER-T	Soft Wire / Combi-Liner Set-up Kit

Cable Parts

Description	Part Number			
	3mt	4mt	5mt	
4	Water Inlet Hose Assembly	AM5012-30	AM5012-40	AM5012-50
5	Outer Liner Assembly	AM6008-30	AM6008-40	AM6008-50
6	Power Cable Assembly	AM6015-30	AM6015-40	AM6015-50
7	Switch Lead Assembly	AM5010-30	AM5010-40	AM5010-50
9	Canvas Cover Assembly	AM5019-30	AM5019-40	AM5019-50
12	Complete Cable Assembly	AM5506-30	AM5506-40	AM5506-50

Welding with Soft Wires

For welding with Aluminum wires use a Soft Wire / Combi-Liner (page 47-48). Optimum installation is achieved when using the Soft Wire / Combi-Liner set-up kit.

M65W/M65WS Liquid-Cooled Mig Welding Torch

M65W/ M65WS Ratings:	580A CO ₂ , 560A mixed gas M21, 400A pulse @100% Max. Load 25KW with 1600W liquid cooler, 0.9mm-2.0mm wires
	550A CO ₂ , 520A mixed gas M21, 360A pulse @100% Max. Load 23KW with 1200W liquid cooler, 0.9mm-2.0mm wires

Ideal for high deposition and pulse applications with high reflected heat.
Fitted with a long neck as standard with an optional shorter version.
A retrofit heat shield is available for high reflected heat applications.

ARC M HIGH PERFORMANCE MIG TORCH PACKAGES

M65W/WS Torches are supplied with a Euro termination as standard and are supplied 'ready to weld' with all wear parts fitted.



M65W Lx:169mm
M65WS Lx:148mm

3mt M65W-3M M65WS-3M	4mt M65W-4M M65WS-4M	5mt M65W-5M M65WS-5M
---	---	---

Wear Parts

Nozzles

Part Number	Description	Bore	Wall	Material
A • AMN55WCN	Conical / Insulator Assy	15mm	3.0mm	Copper
AMN55WTN	Tapered / Insulator Assy	13mm	3.0mm	Copper
AMN55WCYN	Cylindrical/Insulator Assy	17mm	3.0mm	Copper
A1 • AMN55WCN-C	Conical Nozzle c/w Insulator & Retaining Ring			
AMN55WTN-C	Tapered Nozzle c/w Insulator & Retaining Ring			
AMN55WCYN-C	Cylindrical Nozzle c/w Insulator & Retaining Ring			

B Nozzle Retaining Rings

Part Number	Description	Size	Material
• AMN6WCNR	Nozzle Retaining Ring-Pull Off	30.5mm	Brass

C Contact Tips

Part Number	Description	Size (mm)	Wire Size (mm-inch)	Material
Standard Series				
AM6WCT09	Contact Tip	M10*35.5	0.9 - 0.035	CuCrZr
AM6WCT10	Contact Tip	M10*35.5	1.0 - 0.040	CuCrZr
• AM6WCT12	Contact Tip	M10*35.5	1.2 - 0.045	CuCrZr
AM6WCT14	Contact Tip	M10*35.5	1.4 - 0.055	CuCrZr
AM6WCT16	Contact Tip	M10*35.5	1.6 - 0.063	CuCrZr
AM6WCT20	Contact Tip	M10*35.5	2.0 - 0.080	CuCrZr
A Series				
AM6WCT10A	Contact Tip	M10*35.5	1.0 - 0.040	CuCrZr
AM6WCT12A	Contact Tip	M10*35.5	1.2 - 0.045	CuCrZr
AM6WCT16A	Contact Tip	M10*35.5	1.6 - 0.063	CuCrZr
AM6WCT20A	Contact Tip	M10*35.5	2.0 - 0.080	CuCrZr
AMC6WCT10A	Contact Tip	M10*35.5	1.0 - 0.040	Copper
AMC6WCT12A	Contact Tip	M10*35.5	1.2 - 0.045	Copper

• Denotes torch package standard wear part set-up

D Tip Adaptors

Part Number	Description	Material
• AM6OSWTAC-20	High Performance 2.0mm Recess	Copper
AM6OSWTAC-45	High Performance 4.5mm Recess	Copper
AM6OSWTAB-20	Tip Adaptor 2.0mm Recess	Brass
AM6OSWTAB-45	Tip Adaptor 4.5mm Recess	Brass

E Tip Adaptor Insulators

Part Number	Description
• AM55WTAI	Tip Adaptor Insulator

F Liners

Part Number	Description	Wire Size
• AM6SL-1012-30	Steel Liner x 3mt	1.0-1.2mm
• AM6SL-1012-40	Steel Liner x 4mt	1.0-1.2mm
• AM6SL-1012-50	Steel Liner x 5mt	1.0-1.2mm
AM6SL-16-30	Steel Liner x 3mt	1.6mm
AM6SL-16-40	Steel Liner x 4mt	1.6mm
AM6SL-16-50	Steel Liner x 5mt	1.6mm
AM6SL-20-30	Steel Liner x 3mt	2.0mm
AM6SL-20-40	Steel Liner x 4mt	2.0mm
AM6SL-20-50	Steel Liner x 5mt	2.0mm
AM6OSWL-1012-30	Soft Wire Liner x 3mt	1.0-1.2mm
AM6OSWL-1012-40	Soft Wire Liner x 4mt	1.0-1.2mm
AM6OSWL-1620-30	Soft Wire Liner x 3mt	1.6-2.0mm
AM6OSWL-1620-40	Soft Wire Liner x 4mt	1.6-2.0mm

For alternate liner options please refer to page 46-48

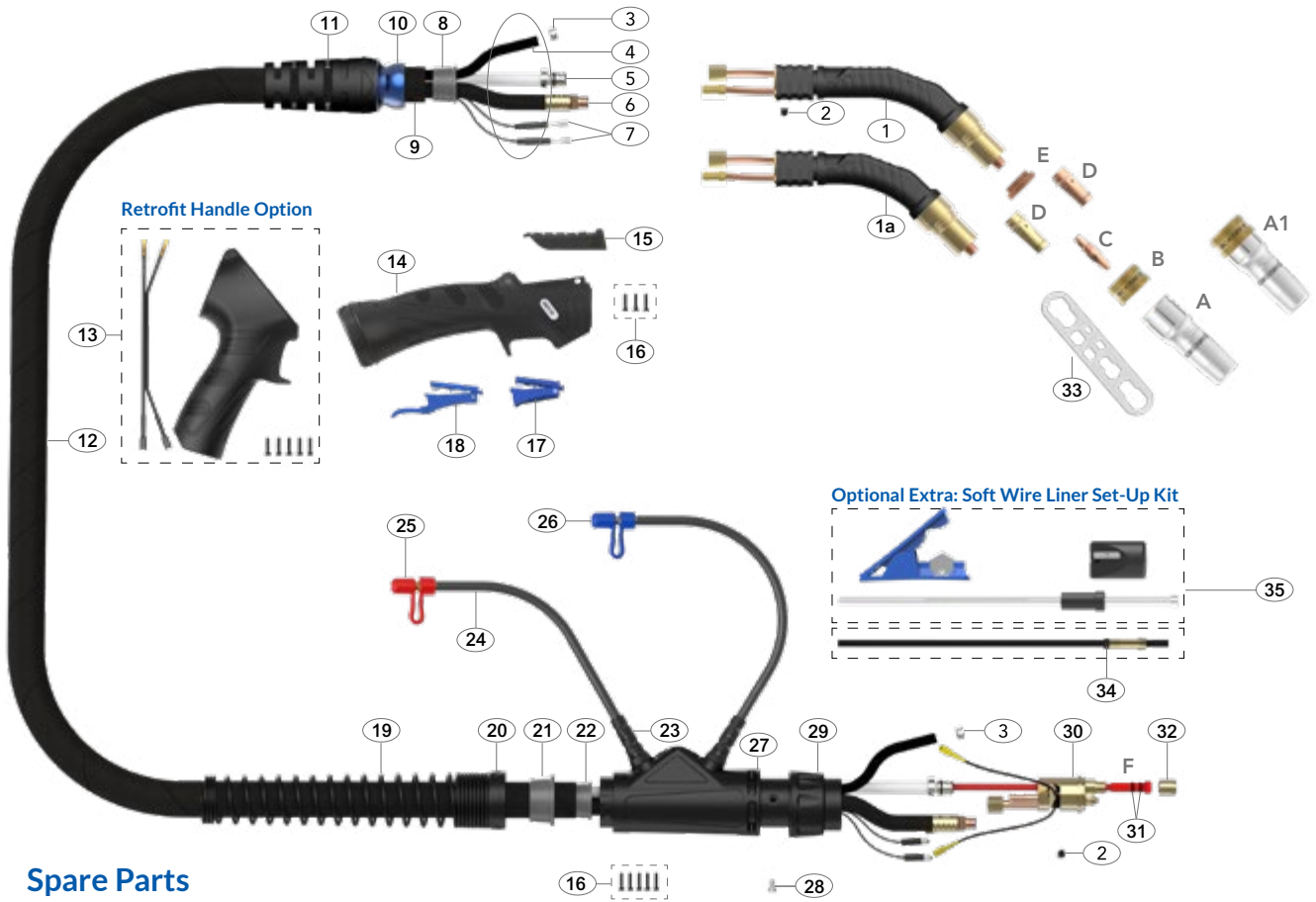

Spare Parts

Part Number	Description
1	AM6502 M65W Swan Neck Assembly 45°
1a	AM6502S M65WS Swan Neck Assembly 45°
2	AM6X5 Outer Liner Retaining Screw
3	AM15400023 Water Hose Clamp 10mm
8	AMS8010 Canvas Cover Retainer
10	AM3208-1 Ball Joint
11	AMS3208-S Cable Support With Nut
14	AM2515 Handle and Lock Nut Assembly
15	AM2515-C Handle Control Cover
16	AMSP1-1 Screw Pack
17	AM2516 Microswitch Standard Trigger
18	AM2516L Microswitch Extended Trigger
19	AM8027 Cable Support Spring
20	AM8028 Housing Lock Nut
21	AM8009 Canvas Cover Clamp
22	AM8010 Canvas Cover Retainer
23	AM1820 Hose Support
24	AM5017 Water Outlet Hose Assembly
25	AM80320 Red Cap Stopper
26	AM80310 Blue Cap Stopper
27	AM5022 Housing Assembly
28	AM1526 Gun Plug Screw (M4 x 0.7)
29	AM1519 Gun Plug Nut
30	AM5098 Water-Cooled Plug Body Assembly
31	AMLOR Liner 'O' Ring
32	AM1826 Liner Retaining Nut
33	AMWS Wear Parts Spanner

Part Number	Description
Optional Extra	
34	AMOSWLG Soft Wire Liner Gasket
35	AMOSW-LINER-T Soft Wire / Combi-Liner Set-up Kit

Retrofit Handle Option

Part Number	Description
13	AMMP2515 Pistol Handle Assembly

Cable Parts

Description	Part Number			
	3mt	4mt	5mt	
4	Water Inlet Hose Assembly	AM5012-30	AM5012-40	AM5012-50
5	Outer Liner Assembly	AM6008-30	AM6008-40	AM6008-50
6	Power Cable Assembly	AM6015-30	AM6015-40	AM6015-50
7	Switch Lead Assembly	AM5010-30	AM5010-40	AM5010-50
9	Canvas Cover Assembly	AM5019-30	AM5019-40	AM5019-50
12	Complete Cable Assembly	AM6006-30	AM6006-40	AM6006-50

Welding with Soft Wires

For welding with Aluminum wires use a Soft Wire / Combi-Liner (page 47-48). Optimum installation is achieved when using the Soft Wire / Combi-Liner set-up kit.

M65WLP Liquid-Cooled Mig Welding Torch

M65WLP Ratings:	590A CO ₂ , 570A mixed gas M21, 420A pulse @100% Max. Load 26KW with 1600W liquid cooler, 0.9mm-2.0mm wires
	560A CO ₂ , 530A mixed gas M21, 380A pulse @100% Max. Load 24KW with 1200W liquid cooler, 0.9mm-2.0mm wires

Ideal for high deposition and pulse applications with high reflected heat.
Suitable for larger wire sizes, the 22 degree neck is better for feeding both stiff and soft wires.
A retrofit heat shield is available for high reflected heat applications.

ARC M HIGH PERFORMANCE MIG TORCH PACKAGES

M65WLP Torches are supplied with a Euro termination as standard and is supplied with a pistol handle and 'ready to weld' with high performance M10 wear parts.



3mt M65WLP-3M	4mt M65WLP-4M	5mt M65WLP-5M
--------------------------------	--------------------------------	--------------------------------

*M65WLP supplied with high performance M10 wear parts.

Wear Parts

Nozzles

Part Number	Description	Bore	Wall	Material
A • AMN55WCN	Conical / Insulator Assy	15mm	3.0mm	Copper
AMN55WTN	Tapered / Insulator Assy	13mm	3.0mm	Copper
AMN55WCYN	Cylindrical/Insulator Assy	17mm	3.0mm	Copper
A1 • AMN55WCN-C	Conical Nozzle c/w Insulator & Retaining Ring			
AMN55WTN-C	Tapered Nozzle c/w Insulator & Retaining Ring			
AMN55WCYN-C	Cylindrical Nozzle c/w Insulator & Retaining Ring			

B Nozzle Retaining Rings

Part Number	Description	Size	Material
• AMN6WCNR	Nozzle Retaining Ring-Pull Off	30.5mm	Brass

C Contact Tips

Part Number	Description	Size (mm)	Wire Size (mm-inch)	Material
Standard Series				
AM6WCT09	Contact Tip	M10*35.5	0.9 - 0.035	CuCrZr
AM6WCT10	Contact Tip	M10*35.5	1.0 - 0.040	CuCrZr
• AM6WCT12	Contact Tip	M10*35.5	1.2 - 0.045	CuCrZr
AM6WCT14	Contact Tip	M10*35.5	1.4 - 0.055	CuCrZr
AM6WCT16	Contact Tip	M10*35.5	1.6 - 0.063	CuCrZr
AM6WCT20	Contact Tip	M10*35.5	2.0 - 0.080	CuCrZr
A Series				
AM6WCT10A	Contact Tip	M10*35.5	1.0 - 0.040	CuCrZr
AM6WCT12A	Contact Tip	M10*35.5	1.2 - 0.045	CuCrZr
AM6WCT16A	Contact Tip	M10*35.5	1.6 - 0.063	CuCrZr
AM6WCT20A	Contact Tip	M10*35.5	2.0 - 0.080	CuCrZr
AMC6WCT10A	Contact Tip	M10*35.5	1.0 - 0.040	Copper
AMC6WCT12A	Contact Tip	M10*35.5	1.2 - 0.045	Copper

• Denotes torch package standard wear part set-up

D Tip Adaptors

Part Number	Description	Material
• AM6OSWTAC-20	High Performance 2.0mm Recess	Copper
AM6OSWTAC-45	High Performance 4.5mm Recess	Copper
AM6OSWTAB-20	Tip Adaptor 2.0mm Recess	Brass
AM6OSWTAB-45	Tip Adaptor 4.5mm Recess	Brass

E Tip Adaptor Insulators

Part Number	Description
• AM55WTAI	Tip Adaptor Insulator

F Liners

Part Number	Description	Wire Size
• AM6SL-1012-30	Steel Liner x 3mt	1.0-1.2mm
• AM6SL-1012-40	Steel Liner x 4mt	1.0-1.2mm
• AM6SL-1012-50	Steel Liner x 5mt	1.0-1.2mm
AM6SL-16-30	Steel Liner x 3mt	1.6mm
AM6SL-16-40	Steel Liner x 4mt	1.6mm
AM6SL-16-50	Steel Liner x 5mt	1.6mm
AM6SL-20-30	Steel Liner x 3mt	2.0mm
AM6SL-20-40	Steel Liner x 4mt	2.0mm
AM6SL-20-50	Steel Liner x 5mt	2.0mm
AM6OSWL-1012-30	Soft Wire Liner x 3mt	1.0-1.2mm
AM6OSWL-1012-40	Soft Wire Liner x 4mt	1.0-1.2mm
AM6OSWL-1620-30	Soft Wire Liner x 3mt	1.6-2.0mm
AM6OSWL-1620-40	Soft Wire Liner x 4mt	1.6-2.0mm

For alternate liner options please refer to page 46-48

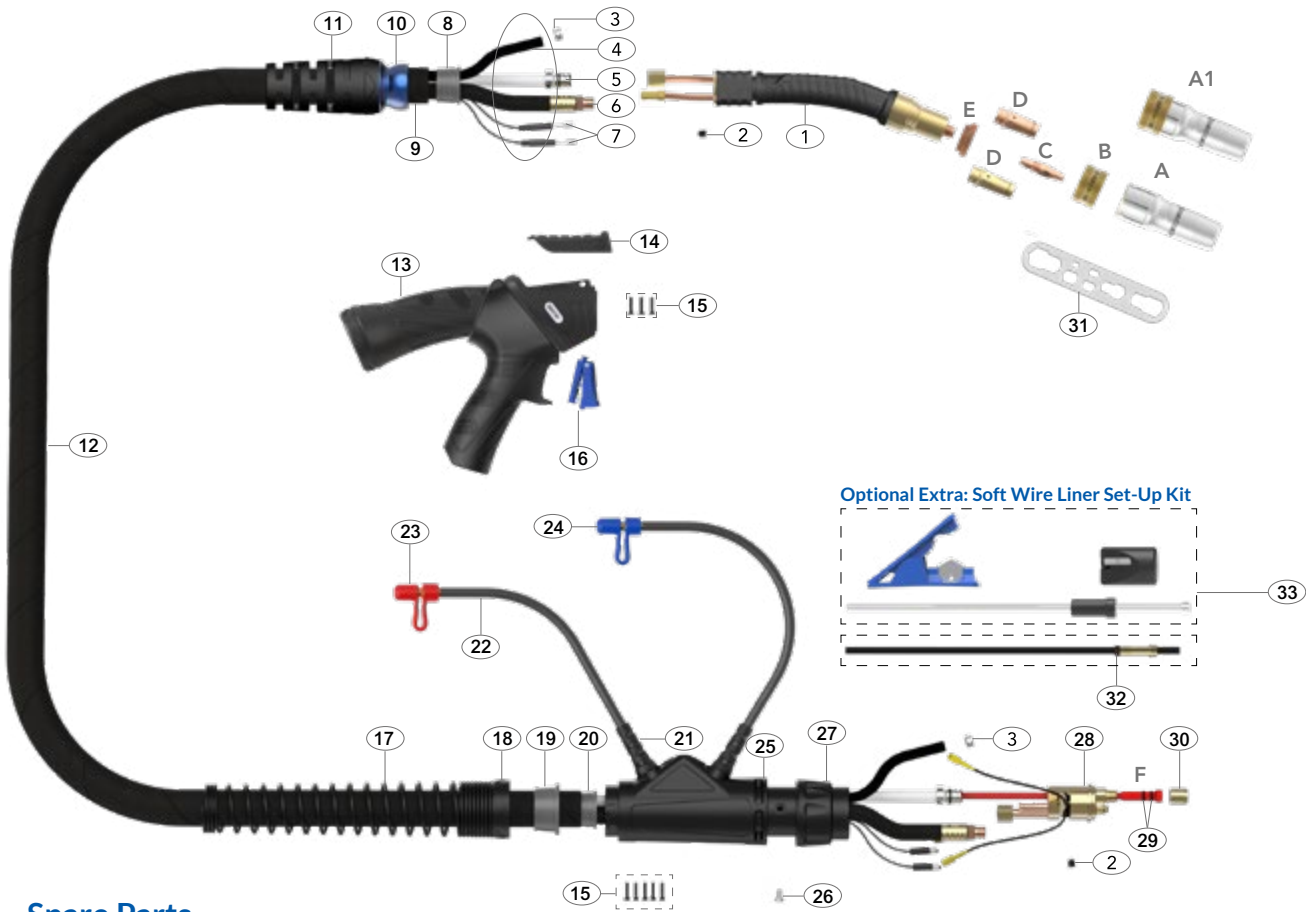

Spare Parts

Part Number	Description
1	AM6502P M65WLP Swan Neck Assembly 22°
2	AM6X5 Outer Liner Retaining Screw
3	AM15400023 Water Hose Clamp 10mm
8	AMS8010 Canvas Cover Retainer
10	AM3208-1 Ball Joint
11	AMS3208-S Cable Support With Nut
13	AMP2515-KJ Handle and Lock Nut Assembly
14	AM2515-C Handle Control Cover
15	AMSP1-1 Screw Pack
16	AM2516 Microswitch Standard Trigger
17	AM8027 Cable Support Spring
18	AM8028 Housing Lock Nut
19	AM8009 Canvas Cover Clamp
20	AM8010 Canvas Cover Retainer
21	AM1820 Hose Support
22	AM5017 Water Outlet Hose Assembly
23	AM80320 Red Cap Stopper
24	AM80310 Blue Cap Stopper
25	AM5022 Housing Assembly
26	AM1526 Gun Plug Screw (M4 x 0.7)
27	AM1519 Gun Plug Nut
28	AM5098 Water-Cooled Plug Body Assembly
29	AMLOR Liner 'O' Ring
30	AM1826 Liner Retaining Nut
31	AMWS Wear Parts Spanner

Part Number	Description
Optional Extra	
32	AMOSWLG Soft Wire Liner Gasket
33	AMOSW-LINER-T Soft Wire / Combi-Liner Set-up Kit

Cable Parts

Description	Part Number		
	3mt	4mt	5mt
4 Water Inlet Hose Assembly	AM5012-30	AM5012-40	AM5012-50
5 Outer Liner Assembly	AM6008-30	AM6008-40	AM6008-50
6 Power Cable Assembly	AM6015-30	AM6015-40	AM6015-50
7 Switch Lead Assembly	AM5010-30	AM5010-40	AM5010-50
9 Canvas Cover Assembly	AM5019-30	AM5019-40	AM5019-50
12 Complete Cable Assembly	AM6006-30	AM6006-40	AM6006-50

Welding with Soft Wires

For welding with Aluminum wires use a Soft Wire / Combi-Liner (page 47-48). Optimum installation is achieved when using the Soft Wire / Combi-Liner set-up kit.

Nozzles

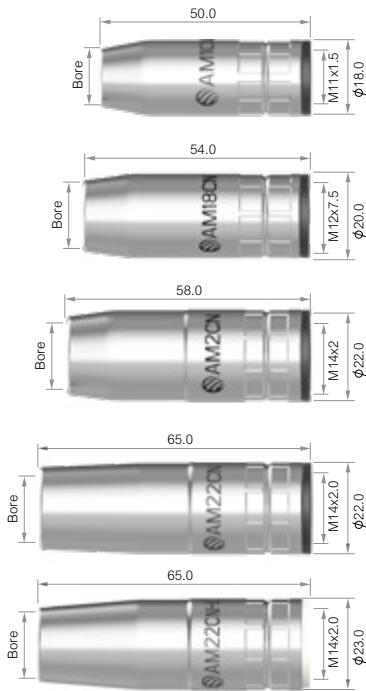

Part No.	Description	Bore	Wall	Material	M1	M18	M2	M22	M2M	M22M
AM1CN	Conical Nozzle Assembly	12mm	1.0mm	Copper	●	●	●	●	●	●
AM1TN	Tapered Nozzle Assembly	10.6mm	1.0mm	Copper	●	●	●	●	●	●
AM18CN	Conical Nozzle Assembly	14mm	1.5mm	Copper	●	●	●	●	●	●
AM18TN	Tapered Nozzle Assembly	12mm	1.5mm	Copper	●	●	●	●	●	●
AM2CN	Conical Nozzle Assembly	15mm	1.9mm	Copper	●	●	●	●	●	●
AM2TN	Tapered Nozzle Assembly	12mm	1.9mm	Copper	●	●	●	●	●	●
AM22CN	Conical Nozzle Assembly	16mm	1.75mm	Copper	●	●	●	●	●	●
AM22TN	Tapered Nozzle Assembly	14mm	1.75mm	Copper	●	●	●	●	●	●
Recommended for High Amperage and Pulse Welding										
AM22CNHD	Conical Nozzle HD Assembly	16mm	2.00mm	Copper	●	●	●	●	●	●

Contact Tips

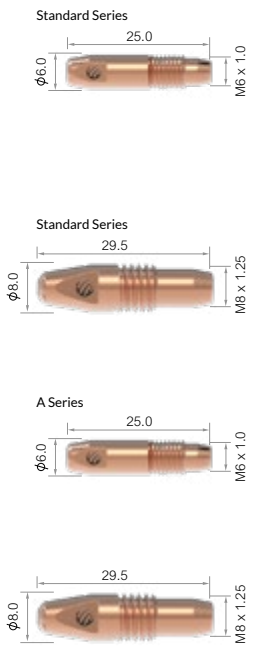

Part No.	Description	Size mm	Wire Size mm-inch	Material	M1	M18	M2	M22	M2M	M22M
Standard Series - Recommended for Fe, Fe-MC/FC Set-up										
AM1CT06	Contact Tip	M6*25.0	0.6-0.023	Copper	●	●	●	●	●	●
AM1CT08	Contact Tip	M6*25.0	0.8-0.030	Copper	●	●	●	●	●	●
AM1CT09	Contact Tip	M6*25.0	0.9-0.035	Copper	●	●	●	●	●	●
AM1CT10	Contact Tip	M6*25.0	1.0-0.040	Copper	●	●	●	●	●	●
AM1CT12	Contact Tip	M6*25.0	1.2-0.045	Copper	●	●	●	●	●	●
Standard Series - Recommended for Fe, Fe-MC/FC Set-up										
AM2CT08	Contact Tip	M8*29.5	0.8-0.030	Copper	●	●	●	●	●	●
AM2CT09	Contact Tip	M8*29.5	0.9-0.035	Copper	●	●	●	●	●	●
AM2CT10	Contact Tip	M8*29.5	1.0-0.040	Copper	●	●	●	●	●	●
AM2CT12	Contact Tip	M8*29.5	1.2-0.045	Copper	●	●	●	●	●	●
A Series - Recommended for Aluminium and SS Set-up										
AM1CT08A	Contact Tip	M6*25.0	0.8-0.030	Copper	●	●	●	●	●	●
AM1CT10A	Contact Tip	M6*25.0	1.0-0.040	Copper	●	●	●	●	●	●
AM1CT12A	Contact Tip	M6*25.0	1.2-0.045	Copper	●	●	●	●	●	●
A Series - Recommended for Aluminium and SS Set-up										
AM2CT08A	Contact Tip	M8*29.5	0.8-0.030	Copper	●	●	●	●	●	●
AM2CT10A	Contact Tip	M8*29.5	1.0-0.040	Copper	●	●	●	●	●	●
AM2CT12A	Contact Tip	M8*29.5	1.2-0.045	Copper	●	●	●	●	●	●

● Standard wear part range ● Torch package standard wear part set-up

Tip Adaptors

Part No.	Description	Material	M1	M18	M2	M22	M2M	M22M
AM1TA	Tip Adaptor	Brass	●	○	○	○	○	○
AM18TA	Tip Adaptor	Brass	○	●	○	○	○	○
AM2TA	Tip Adaptor	Brass	○	○	●	○	●	○
AM22TA	Tip Adaptor	Brass	○	○	○	●	○	●



○ Standard wear part range ● Torch package standard wear part set-up

Liners

Filler Metal

Steel Liner Recommended for: Fe, Fe-MC/FC. Light and medium duty applications

Part No.	Description	Nipple	Wire Size mm	M1	M18	M2	M22	M2M	M22M
AM1535-30	Steel Liner x 3mt	Moulded Nipple	0.6-0.9	●	●	●	●	●	●
AM1535-40	Steel Liner x 4mt	Moulded Nipple	0.6-0.9	●	●	●	●	●	●
AM1535-50	Steel Liner x 5mt	Moulded Nipple	0.6-0.9	●	●	●	●	●	●



AM2524-30	Steel Liner x 3mt	Moulded Nipple	1.0-1.2	●	●	●	●	●	●
AM2524-40	Steel Liner x 4mt	Moulded Nipple	1.0-1.2	●	●	●	●	●	●
AM2524-50	Steel Liner x 5mt	Moulded Nipple	1.0-1.2	●	●	●	●	●	●



AM2MJL	Neck Jump Liner - Hard Wire(L:170mm)	Brass Nipple	0.8-1.2	●	●	●	●	●	●
AM22MJL	Neck Jump Liner - Hard Wire(L:186.5mm)	Brass Nipple	0.8-1.2	●	●	●	●	●	●

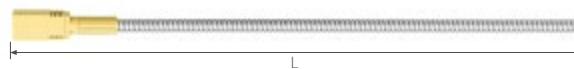

AI - Combi Liner Recommended for: Air-Cooled torches, Can be used for SS-MC/FC wires

AM1564-30	Combi-Liner x 3mt	Brass Nipple	0.8-1.2	●	●	●	●	●	●
AM1564-40	Combi-Liner x 4mt	Brass Nipple	0.8-1.2	●	●	●	●	●	●
AM1564-50	Combi-Liner x 5mt	Brass Nipple	0.8-1.2	●	●	●	●	●	●



AI - Soft Wire Liner Recommended for: Air-Cooled torches, Can be used for SS-MC/FC wires

AM1564A-30	Soft Wire Liner x 3mt	Brass Nipple	0.8-1.2	●	●	●	●	●	●
AM1564A-40	Soft Wire Liner x 4mt	Brass Nipple	0.8-1.2	●	●	●	●	●	●
AM1564A-50	Soft Wire Liner x 5mt	Brass Nipple	0.8-1.2	●	●	●	●	●	●



AM2MJL-B	Neck Jump Liner - Soft Wire(L:170mm)	Brass Nipple	0.8-1.2	●	●	●	●	●	●
AM22MJL-B	Neck Jump Liner - Soft Wire(L:186.5mm)	Brass Nipple	0.8-1.2	●	●	●	●	●	●





Welding with Soft Wires

For welding with Aluminum wires use a Combi-liner.
Optimum installation is achieved when using the Combi-liner set-up kit.

● Standard wear part range ● Torch package standard wear part set-up

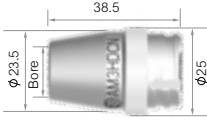
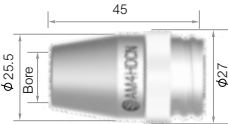
Air-Cooled Nozzles - 2 Piece

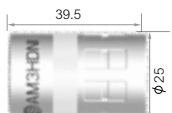
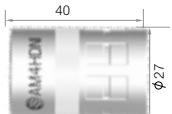
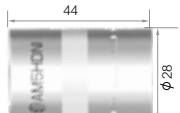
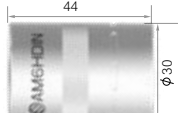
Part No.	Description	Bore	Wall	Material	Thread				
					M3	M4	M5	M6	
	AM3HDTN	Tapered Nozzle	12mm	3mm	Copper	●	●	●	●
	AM3HDCN	Conical Nozzle	14mm	3mm	Copper	●	●	●	●
	AM3HDCYN	Cylindrical Nozzle	19mm	3mm	Copper	●	●	●	●
	AM4HDTN	Tapered Nozzle	13mm	3mm	Copper	●	●	●	●
	AM4HDCN	Conical Nozzle	15mm	3mm	Copper	●	●	●	●
	AM4HDCYN	Cylindrical Nozzle	21mm	3mm	Copper	●	●	●	●
	AM5HDTN	Tapered Nozzle	13mm	3.5mm	Copper	●	●	●	●
	AM5HDCN	Conical Nozzle	15mm	3.5mm	Copper	●	●	●	●
	AM5HDCYN	Cylindrical Nozzle	21mm	3.5mm	Copper	●	●	●	●
	AM6HDTN	Tapered Nozzle	13mm	3.5mm	Copper	●	●	●	●
	AM6HDCN	Conical Nozzle	15mm	3.5mm	Copper	●	●	●	●
	AM6HDCYN	Cylindrical Nozzle	23mm	3.5mm	Copper	●	●	●	●
	AM3HDNI	Nozzle Insulator				●	●	●	●
	AM4HDNI	Nozzle Insulator				●	●	●	●
	AM5HDNI	Nozzle Insulator				●	●	●	●
	AM6HDNI	Nozzle Insulator				●	●	●	●

● Standard wear part range ● Torch package standard wear part set-up

Air-Cooled Nozzles - Single Piece

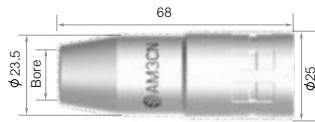

Part No.	Description	Bore	Wall	Material	M3	M4	M5	M6
AM3TN	Tapered Nozzle / Insulator Assy	12mm	2.25mm	Copper	●	●	●	●
AM3CN	Conical Nozzle / Insulator Assy	14mm	2.25mm	Copper	●	●	●	●
AM3CYN	Cylindrical Nozzle / Insulator Assy	19mm	2.25mm	Copper	●	●	●	●



AM4TN	Tapered Nozzle / Insulator Assy	13mm	2.25mm	Copper	●	●	●	●
AM4CN	Conical Nozzle / Insulator Assy	15mm	2.25mm	Copper	●	●	●	●
AM4CYN	Cylindrical Nozzle / Insulator Assy	21mm	2.25mm	Copper	●	●	●	●

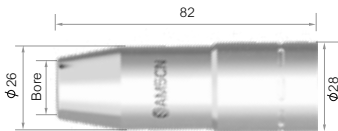

AM5TN	Tapered Nozzle / Insulator Assy	13mm	2.5mm	Copper	●	●	●	●
AM5CN	Conical Nozzle / Insulator Assy	15mm	2.5mm	Copper	●	●	●	●
AM5CYN	Cylindrical Nozzle / Insulator Assy	21mm	2.5mm	Copper	●	●	●	●



AM6TN	Tapered Nozzle / Insulator Assy	13mm	2.5mm	Copper	●	●	●	●
AM6CN	Conical Nozzle / Insulator Assy	15mm	2.5mm	Copper	●	●	●	●
AM6CYN	Cylindrical Nozzle / Insulator Assy	23mm	2.5mm	Copper	●	●	●	●

Liquid-Cooled Nozzles - Separate



Part No.	Description	Bore	Wall	Material	M5W	M55W	M65W/WS	M65WLP
AMN5WCN	Conical / Insulator Assy	13.5mm	3.0mm	Copper	●	●	●	●
AMN5WTN	Tapered / Insulator Assy	11.5mm	3.0mm	Copper	●	●	●	●
AMN5WCYN	Cylindrical / Insulator Assy	16.0mm	3.0mm	Copper	●	●	●	●



AMN55WCN	Conical / Insulator Assy	15mm	3.0mm	Copper	●	●	●	●
AMN55WTN	Tapered / Insulator Assy	13mm	3.0mm	Copper	●	●	●	●
AMN55WCYN	Cylindrical / Insulator Assy	17mm	3.0mm	Copper	●	●	●	●

● Standard wear part range ● Torch package standard wear part set-up

Nozzle Retaining Rings



Part No.	Description	Size	Material	M5W M55W M65W/WS M65WLP
AMN5WCNR	Nozzle Retaining Ring	29.5mm	Brass	● ○ ○ ○
AMN6WCNR	Nozzle Retaining Ring	30.5mm	Brass	○ ● ● ●

Liquid-Cooled Nozzles -Complete



Part No.	Description	M5W M55W M65W/WS M65WLP
AMN5WCN-C	Conical Nozzle c/w Insulator and Retaining Ring	● ○ ○ ○
AMN5WTN-C	Tapered Nozzle c/w Insulator and Retaining Ring	● ○ ○ ○
AMN5WCYN-C	Cylindrical Nozzle c/w Insulator and Retaining Ring	● ○ ○ ○
AMN55WCN-C	Conical Nozzle c/w Insulator and Retaining Ring	○ ● ● ●
AMN55WTN-C	Tapered Nozzle c/w Insulator and Retaining Ring	○ ● ● ●
AMN55WCYN-C	Cylindrical Nozzle c/w Insulator and Retaining Ring	○ ● ● ●

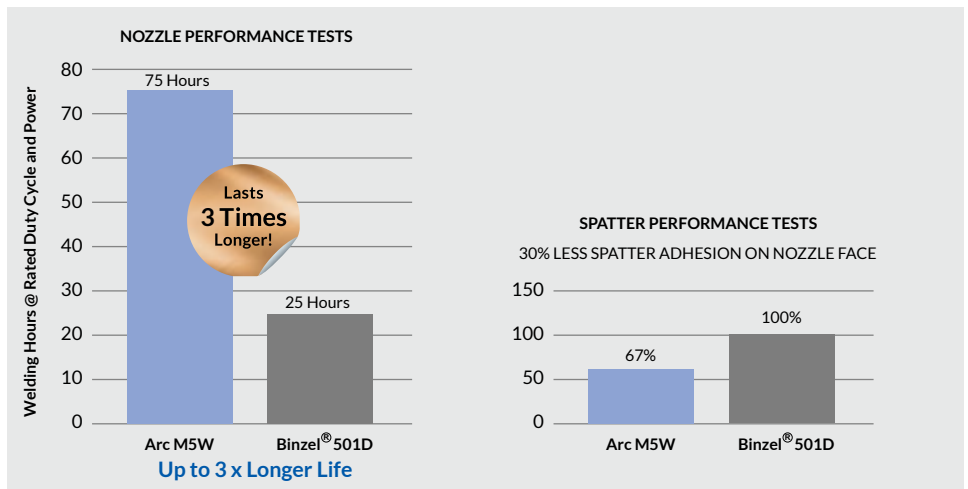

© All trademarks are the property of their respective owners and usage is for cross reference only

○ Standard wear part range ● Torch package standard wear part set-up

Contact Tips



Part No.	Description	Size mm	Wire Size mm-inch	Material	Wire Type	M3 Air-Cooled	M4	M5	M6	M5W Liquid-Cooled	M55W	M65W/WS	M65WLP
Standard Series - Recommended for Fe, Fe-MC/FC Set-up													
AM5CT09	Contact Tip	M8*29.5	0.9-0.035	CuCrZr		●	●	●	●	●	●	●	●
AM5CT10	Contact Tip	M8*29.5	1.0-0.040	CuCrZr	Fe, Fe-FC/MC	●	●	●	●	●	●	●	●
AM5CT12	Contact Tip	M8*29.5	1.2-0.045	CuCrZr	SS,SS-FC/MC	●	●	●	●	●	●	●	●
AM5CT14	Contact Tip	M8*29.5	1.4-0.055	CuCrZr	upto 1.2mm	●	●	●	●	●	●	●	●
AM5CT16	Contact Tip	M8*29.5	1.6-0.063	CuCrZr		●	●	●	●	●	●	●	●

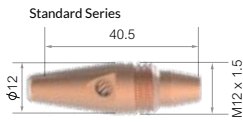

Standard Series - Recommended for Fe, Fe-MC/FC Set-up													
AM6CT09	Contact Tip	M12*40.5	0.9-0.035	CuCrZr		●	●	●	●	●	●	●	●
AM6CT10	Contact Tip	M12*40.5	1.0-0.040	CuCrZr		●	●	●	●	●	●	●	●
AM6CT12	Contact Tip	M12*40.5	1.2-0.045	CuCrZr	Fe, Fe-FC/MC	●	●	●	●	●	●	●	●
AM6CT14	Contact Tip	M12*40.5	1.4-0.055	CuCrZr	SS,SS-FC/MC	●	●	●	●	●	●	●	●
AM6CT16	Contact Tip	M12*40.5	1.6-0.063	CuCrZr	upto 1.2mm	●	●	●	●	●	●	●	●
AM6CT20	Contact Tip	M12*40.5	2.0-0.080	CuCrZr		●	●	●	●	●	●	●	●



Standard Series - Recommended for Fe, Fe-MC/FC Set-up													
AM6WCT09	Contact Tip	M10*35.5	0.9-0.035	CuCrZr		●	●	●	●	●	●	●	●
AM6WCT10	Contact Tip	M10*35.5	1.0-0.040	CuCrZr	Fe, Fe-FC/MC	●	●	●	●	●	●	●	●
AM6WCT12	Contact Tip	M10*35.5	1.2-0.045	CuCrZr	SS,SS-FC/MC	●	●	●	●	●	●	●	●
AM6WCT14	Contact Tip	M10*35.5	1.4-0.055	CuCrZr	upto 1.2mm	●	●	●	●	●	●	●	●
AM6WCT16	Contact Tip	M10*35.5	1.6-0.063	CuCrZr		●	●	●	●	●	●	●	●
AM6WCT20	Contact Tip	M10*35.5	2.0-0.080	CuCrZr		●	●	●	●	●	●	●	●



A Series - Recommended for Aluminium and SS Set-up													
AM5CT10A	Contact Tip	M8*29.5	1.0-0.040	CuCrZr		●	●	●	●	●	●	●	●
AM5CT12A	Contact Tip	M8*29.5	1.2-0.045	CuCrZr		●	●	●	●	●	●	●	●
AM5CT16A	Contact Tip	M8*29.5	1.6-0.063	CuCrZr	Aluminium	●	●	●	●	●	●	●	●
AM2CT10A	Contact Tip	M8*29.5	1.0-0.040	Copper	SS,SS-FC/MC	●	●	●	●	●	●	●	●
AM2CT12A	Contact Tip	M8*29.5	1.2-0.045	Copper	upto 1.6mm	●	●	●	●	●	●	●	●

● Standard wear part range ● Torch package standard wear part set-up

Contact Tips

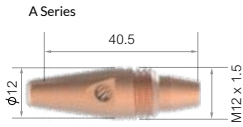

Part No.	Description	Size mm	Wire Size mm-Inch	Material	Wire Type	M3 Air-Cooled	M4	M5	M6	M5W Liquid-Cooled	M55W	M65W/WS	M65WLP
A Series - Recommended for Aluminium and SS Set-up													
AM6CT10A	Contact Tip	M12*40.5	1.0-0.040	CuCrZr	Aluminium SS, SS-FC/MC upto 1.6mm	●	●	●	●	●	●	●	●
AM6CT12A	Contact Tip	M12*40.5	1.2-0.045	CuCrZr		●	●	●	●	●	●	●	●
AM6CT16A	Contact Tip	M12*40.5	1.6-0.063	CuCrZr		●	●	●	●	●	●	●	●
AM6CT20A	Contact Tip	M12*40.5	1.0-0.040	CuCrZr		●	●	●	●	●	●	●	●
AMC6CT10A	Contact Tip	M12*40.5	1.2-0.045	Copper		●	●	●	●	●	●	●	●
AMC6CT12A	Contact Tip	M12*40.5	2.0-0.080	Copper		●	●	●	●	●	●	●	●

A Series - Recommended for Aluminium and SS Set-up													
AM6WCT10A	Contact Tip	M10*35.5	1.0-0.040	CuCrZr	Aluminium SS, SS-FC/MC 1.6mm	●	●	●	●	●	●	●	●
AM6WCT12A	Contact Tip	M10*35.5	1.2-0.045	CuCrZr		●	●	●	●	●	●	●	●
AM6WCT16A	Contact Tip	M10*35.5	1.6-0.063	CuCrZr		●	●	●	●	●	●	●	●
AM6WCT20A	Contact Tip	M10*35.5	2.0-0.080	CuCrZr		●	●	●	●	●	●	●	●
AMC6WCT10A	Contact Tip	M10*35.5	1.0-0.040	Copper		●	●	●	●	●	●	●	●
AMC6WCT12A	Contact Tip	M10*35.5	1.2-0.045	Copper		●	●	●	●	●	●	●	●

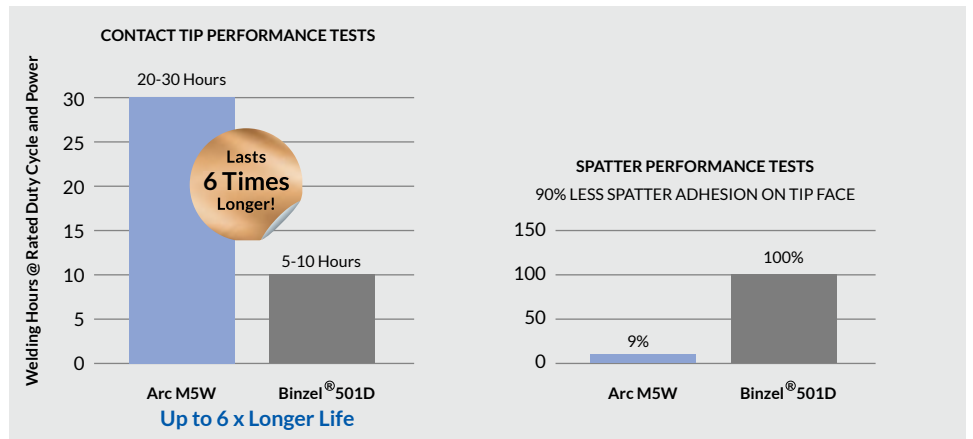

® All trademarks are the property of their respective owners and usage is for cross reference only

● Standard wear part range ● Torch package standard wear part set-up

Tip Adaptors

M3 M4 M5 M6 M5W M55W M65W/WS M65WLP
Air-Cooled Liquid-Cooled

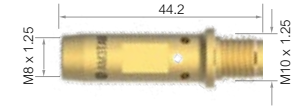

Part No.	Description	Length	Material	Transfer	Amps / Pulse	M3	M4	M5	M6	M5W	M55W	M65W/WS	M65WLP
Recommended for high amperages, high duty and pulse welding. Tips run cooler													
AM3TAC	Tip Adaptor High Performance	44.2mm	CuCrZr		High Current Pulse	●	●	●	●	●	●	●	●
AM3TAB	Tip Adaptor	44.2mm	Brass		Low Current Pulse	●	●	●	●	●	●	●	●

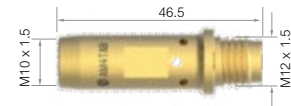

AM4TAC	Tip Adaptor High Performance	46.5mm	CuCrZr		High Current Pulse	●	●	●	●	●	●	●	●
AM4TAB	Tip Adaptor	46.5mm	Brass		Low Current Pulse	●	●	●	●	●	●	●	●

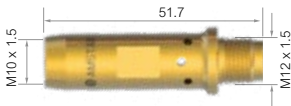

Recommended for high amperages, high duty and pulse welding. Tips run cooler													
AM5TAC	Tip Adaptor High Performance	51.7mm	CuCrZr		High Current Pulse	●	●	●	●	●	●	●	●
AM5TAB	Tip Adaptor	51.7mm	Brass		Low Current Pulse	●	●	●	●	●	●	●	●

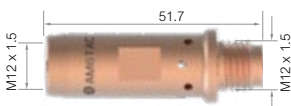

AM6TAC	Tip Adaptor High Performance	51.7mm	CuCrZr		High Current Pulse	●	●	●	●	●	●	●	●
AM6TAB	Tip Adaptor	51.7mm	Brass		Low Current Pulse	●	●	●	●	●	●	●	●



Recommended for high amperages, high duty and pulse welding. Tips run cooler													
AM5WTAC-20	High Performance 2.0mm Recess	34.5mm	Copper	Short Circuit	<200A Low Current Pulse	●	●	●	●	●	●	●	●
AM5WTAC-45	High Performance 4.5mm Recess	32mm	Copper	Spray	>200A High Current Pulse	●	●	●	●	●	●	●	●



AM5WTAB-20	Tip Adaptor 2.0mm Recess	34.5mm	Brass	Short Circuit	<200A Low Current Pulse	●	●	●	●	●	●	●	●
AM5WTAB-45	Tip Adaptor 4.5mm Recess	32mm	Brass	Spray	>200A High Current Pulse	●	●	●	●	●	●	●	●

● Standard wear part range ● Torch package standard wear part set-up

Tip Adaptors

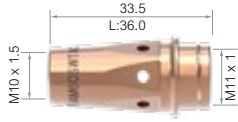

Part No.	Description	Length	Material	Transfer	Amps / Pulse	M3 Air-Cooled	M4	M5	M6	M5W Liquid-Cooled	M55W	M65W/WS	M65WLP
Recommended for high amperages, high duty and pulse welding. Tips run cooler													
AM6OSWTAC-20	High Performance 2.0mm Recess	36.0mm	Copper	Short Circuit	<200A Low Current Pulse	●	●	●	●	●	●	●	●
AM6OSWTAC-45	High Performance 4.5mm Recess	33.5mm	Copper	Spray	>200A High Current Pulse	●	●	●	●	●	●	●	●
AM6OSWTAB-20	Tip Adaptor 2.0mm Recess	36.0mm	Brass	Short Circuit	<200A Low Current Pulse	●	●	●	●	●	●	●	●
AM6OSWTAB-45	Tip Adaptor 4.5mm Recess	33.5mm	Brass	Spray	>200A High Current Pulse	●	●	●	●	●	●	●	●

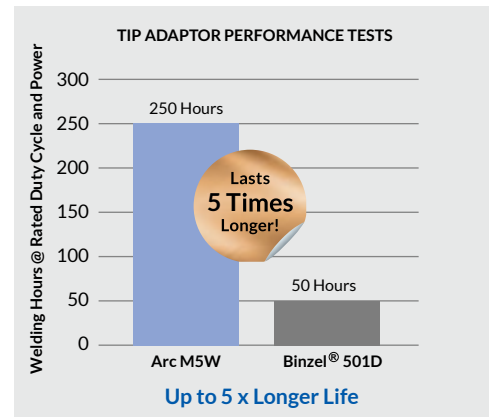

® All trademarks are the property of their respective owners and usage is for cross reference only

Tip Adaptor Insulators

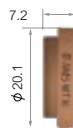

Part No.	Description	M3 Air-Cooled	M4	M5	M6	M5W Liquid-Cooled	M55W	M65W/WS	M65WLP
AM5WTAI	Tip Adaptor Insulator	●	●	●	●	●	●	●	●
AM55WTAI	Tip Adaptor Insulator	●	●	●	●	●	●	●	●

● Standard wear part range ● Torch package standard wear part set-up

Liners

Filler Metal

Steel Liner Recommended for: Fe, Fe-MC/FC. Light and medium duty applications

Part No.	Description	Nipple	Wire Size mm	M3 Air-Cooled	M4	M5	M6	M5W Liquid-Cooled	M55W	M65W/WS	M65WLP
AM1535-30	Steel Liner x 3mt	Moulded Nipple	0.6-0.9	●	●	●	●	●	●	●	●
AM1535-40	Steel Liner x 4mt	Moulded Nipple	0.6-0.9	●	●	●	●	●	●	●	●
AM1535-50	Steel Liner x 5mt	Moulded Nipple	0.6-0.9	●	●	●	●	●	●	●	●



AM2524-30	Steel Liner x 3mt	Moulded Nipple	1.0-1.2	●	●	●	●	●	●	●	●
AM2524-40	Steel Liner x 4mt	Moulded Nipple	1.0-1.2	●	●	●	●	●	●	●	●
AM2524-50	Steel Liner x 5mt	Moulded Nipple	1.0-1.2	●	●	●	●	●	●	●	●



Filler Metal Fe, Fe-MC/FC

Steel Liner Recommended for: Light and medium duty applications

Part No.	Description	Contact Tip	Wire Size mm	M3 Air-Cooled	M4	M5	M6	M5W Liquid-Cooled	M55W	M65W/WS	M65WLP
AM6SL-1012-30	Steel Liner x 3mt	Standard Series	1.0-1.2	●	●	●	●	●	●	●	●
AM6SL-1012-40	Steel Liner x 4mt	Standard Series	1.0-1.2	●	●	●	●	●	●	●	●
AM6SL-1012-50	Steel Liner x 5mt	Standard Series	1.0-1.2	●	●	●	●	●	●	●	●



AM6SL-16-30	Steel Liner x 3mt	Standard Series	1.6	●	●	●	●	●	●	●	●
AM6SL-16-40	Steel Liner x 4mt	Standard Series	1.6	●	●	●	●	●	●	●	●
AM6SL-16-50	Steel Liner x 5mt	Standard Series	1.6	●	●	●	●	●	●	●	●



AM6SL-20-30	Steel Liner x 3mt	Standard Series	2.0	●	●	●	●	●	●	●	●
AM6SL-20-40	Steel Liner x 4mt	Standard Series	2.0	●	●	●	●	●	●	●	●
AM6SL-20-50	Steel Liner x 5mt	Standard Series	2.0	●	●	●	●	●	●	●	●



● Standard wear part range ● Torch package standard wear part set-up

Liners

Filler Metal $SS, SS-MC/FC$

Stainless Steel Liner Recommended for: Heavy Duty Fe. High amperages and heavy deposition welding

Part No.	Description	Contact Tip	Wire Size mm	M3 Air-Cooled	M4	M5	M6	M5W Liquid-Cooled	M55W	M65W/WS	M65WLP
AM6SSTL-1012-30	Stainless Steel Liner x 3mt	Standard Series	1.0-1.2	●	●	●	●	●	●	●	●
AM6SSTL-1012-40	Stainless Steel Liner x 4mt	Standard Series	1.0-1.2	●	●	●	●	●	●	●	●
AM6SSTL-1012-50	Stainless Steel Liner x 5mt	Standard Series	1.0-1.2	●	●	●	●	●	●	●	●



AM6SSTL-16-30	Stainless Steel Liner x 3mt	A Series	1.6	●	●	●	●	●	●	●	●
AM6SSTL-16-40	Stainless Steel Liner x 4mt	A Series	1.6	●	●	●	●	●	●	●	●
AM6SSTL-16-50	Stainless Steel Liner x 5mt	A Series	1.6	●	●	●	●	●	●	●	●



Filler Metal $AlMg$

Al - Combi Liner Recommended for: Air-Cooled torches, Can be used for SS-MC/FC wires

Part No.	Description	Contact Tip	Wire Size mm	M3 Air-Cooled	M4	M5	M6	M5W Liquid-Cooled	M55W	M65W/WS	M65WLP
AM1564-30	Combi-Liner x 3mt	A Series	0.8-1.2	●	●	●	●	●	●	●	●
AM1564-40	Combi-Liner x 4mt	A Series	0.8-1.2	●	●	●	●	●	●	●	●
AM1564-50	Combi-Liner x 5mt	A Series	0.8-1.2	●	●	●	●	●	●	●	●



Al - Combi Liner Recommended for: Liquid-Cooled torches and frequent /repetitive arc starts

AM6CL-1012-30	Combi-Liner x 3mt	A Series	1.0-1.2	●	●	●	●	●	●	●	●
AM6CL-1012-40	Combi-Liner x 4mt	A Series	1.0-1.2	●	●	●	●	●	●	●	●
AM6CL-1012-50	Combi-Liner x 5mt	A Series	1.0-1.2	●	●	●	●	●	●	●	●



● Standard wear part range ● Torch package standard wear part set-up

Liners

Filler Metal ^{AlMg}

Al - Combi Liner Recommended for: Liquid-cooled torches and frequent /repetitive arc starts

Part No.	Description	Contact Tip	Wire Size mm	M3 Air-Cooled	M4	M5	M6	M5W Liquid-Cooled	M55W	M65W/WS	M65WLP
AM6CL-1620-30	Combi-Liner x 3mt	A Series	1.6	●	●	●	●	●	●	●	●
AM6CL-1620-40	Combi-Liner x 4mt	A Series	1.6	●	●	●	●	●	●	●	●
AM6CL-1620-50	Combi-Liner x 5mt	A Series	1.6	●	●	●	●	●	●	●	●



Filler Metal ^{AlMg}

Al - Soft Wire Liner Recommended for: Liquid-cooled torches, AISi, Pure Al and copper wires

Part No.	Description	Contact Tip	Wire Size mm	M3 Air-Cooled	M4	M5	M6	M5W Liquid-Cooled	M55W	M65W/WS	M65WLP
AM6OSWL-1012-30	Soft Wire Liner x 3mt	A Series	1.0-1.2	●	●	●	●	●	●	●	●
AM6OSWL-1012-40	Soft Wire Liner x 4mt	A Series	1.0-1.2	●	●	●	●	●	●	●	●
AM6OSWL-1620-30	Soft Wire Liner x 3mt	A Series	1.6-2.0	●	●	●	●	●	●	●	●
AM6OSWL-1620-40	Soft Wire Liner x 4mt	A Series	1.6-2.0	●	●	●	●	●	●	●	●



AMOSW_LINER-T	Soft Wire / Combi-Liner Set-up Kit	●	●	●	●	●	●	●	●	●	●
---------------	------------------------------------	---	---	---	---	---	---	---	---	---	---

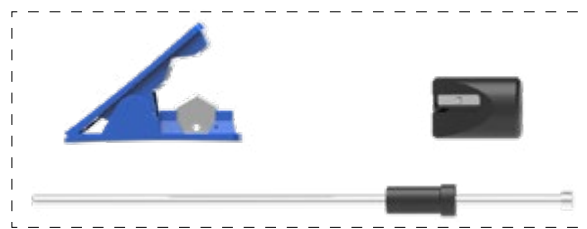

● Standard wear part range ● Torch package standard wear part set-up

SAY HELLO

TO OUR VISION OF THE FUTURE

Arc T

ARC M SERIES

Make Work Life Easier

MPA001 / 2023.08



MAKE WORK
LIFE EASIER